

# *Dimensional Drawing Review*

Marquis Series • Sound Power • Venue Series



The following review is designed to supplement the specification sheets, offering more detailed dimensions and corrections for some discrepancies on the originals. For the most accurate dimensions available, please use this document.

## Contents

MS26 .....	3
MS26 Yoke Bracket .....	4
MS28 .....	5
MS28 Yoke Bracket .....	6
MS105, MS115 .....	7
MS112 .....	8
MS125S .....	9
SP212-A/9 .....	10
SP222 .....	11
SP215-6/9 .....	12
SP225-6/9 .....	13
SP125S .....	14
SP128S .....	15
VS2110 .....	16
VS2210-6/9 .....	17
VS3115 .....	18
VS3215-6/9 .....	19
VS3218-6/9 .....	20
VS125HS .....	21

Part # WP INSTALL DRAW

# MS26

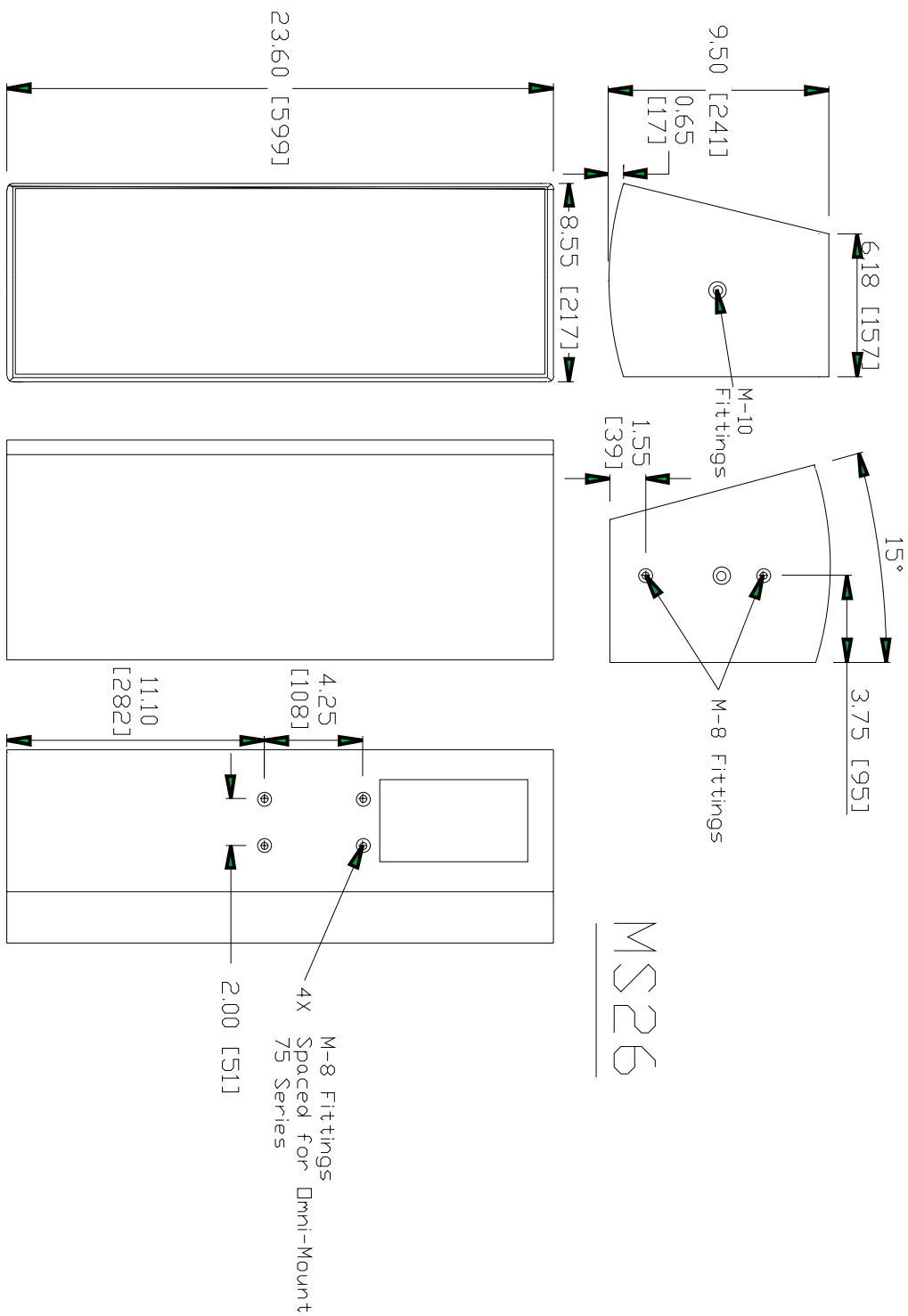

# MS26

\* **Important!** Dimensions are in inches [millimeters]. Please note that all measurements are OD (outside dimensions). Due to the nature of construction and the DuraFlex™ finish, all measurements may vary ± 0.039 in (± 1 mm).

# MS26 Yoke Bracket

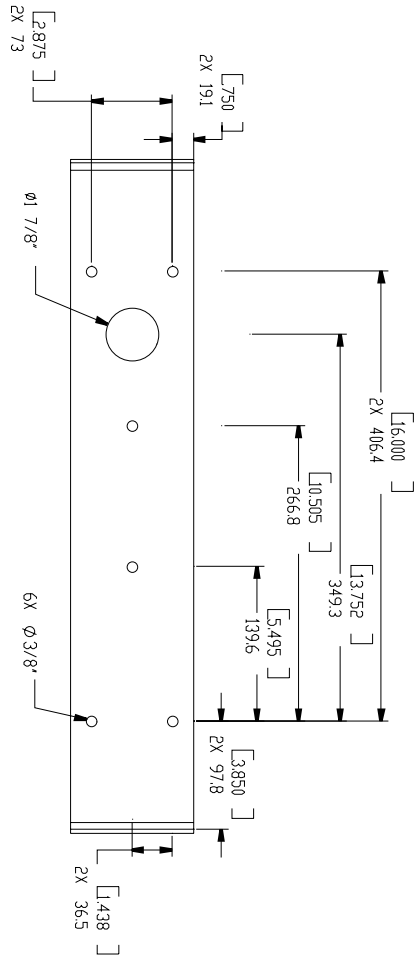

## MS26 Yoke Bracket

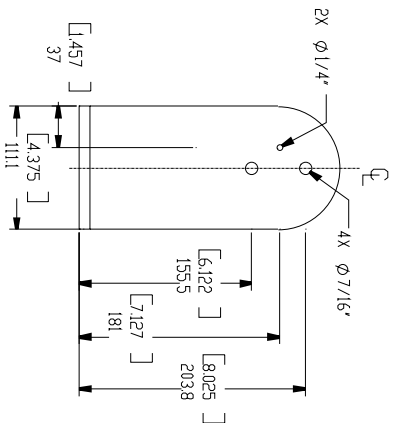
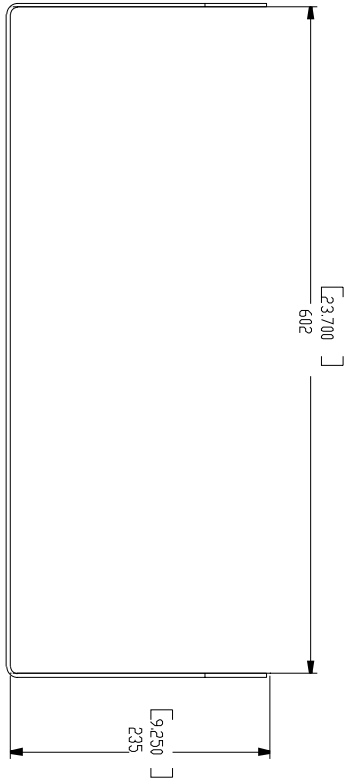

\* Dimensions are in millimeters [inches].



# MS28 Yoke Bracket

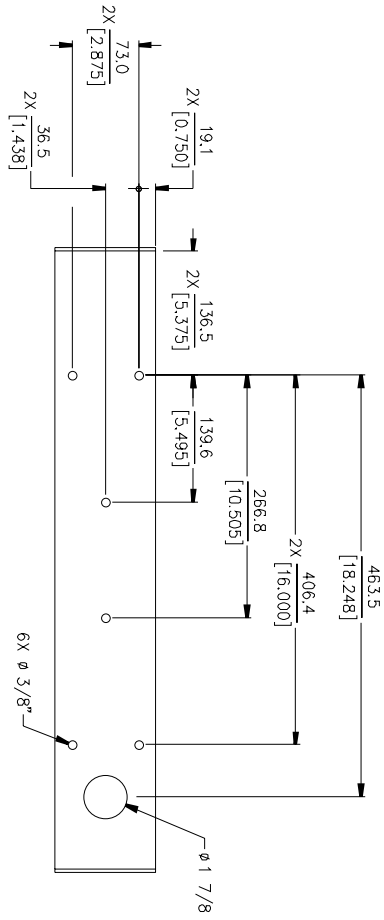

## MS28 Yoke Bracket

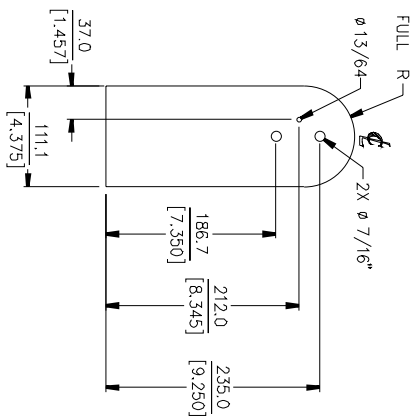
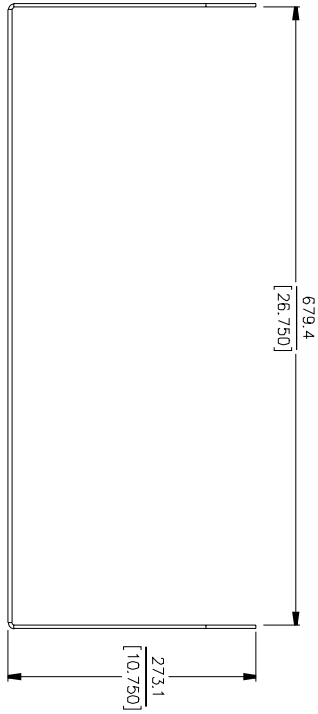

\* Dimensions are in millimeters [inches].

# MS105, MS115

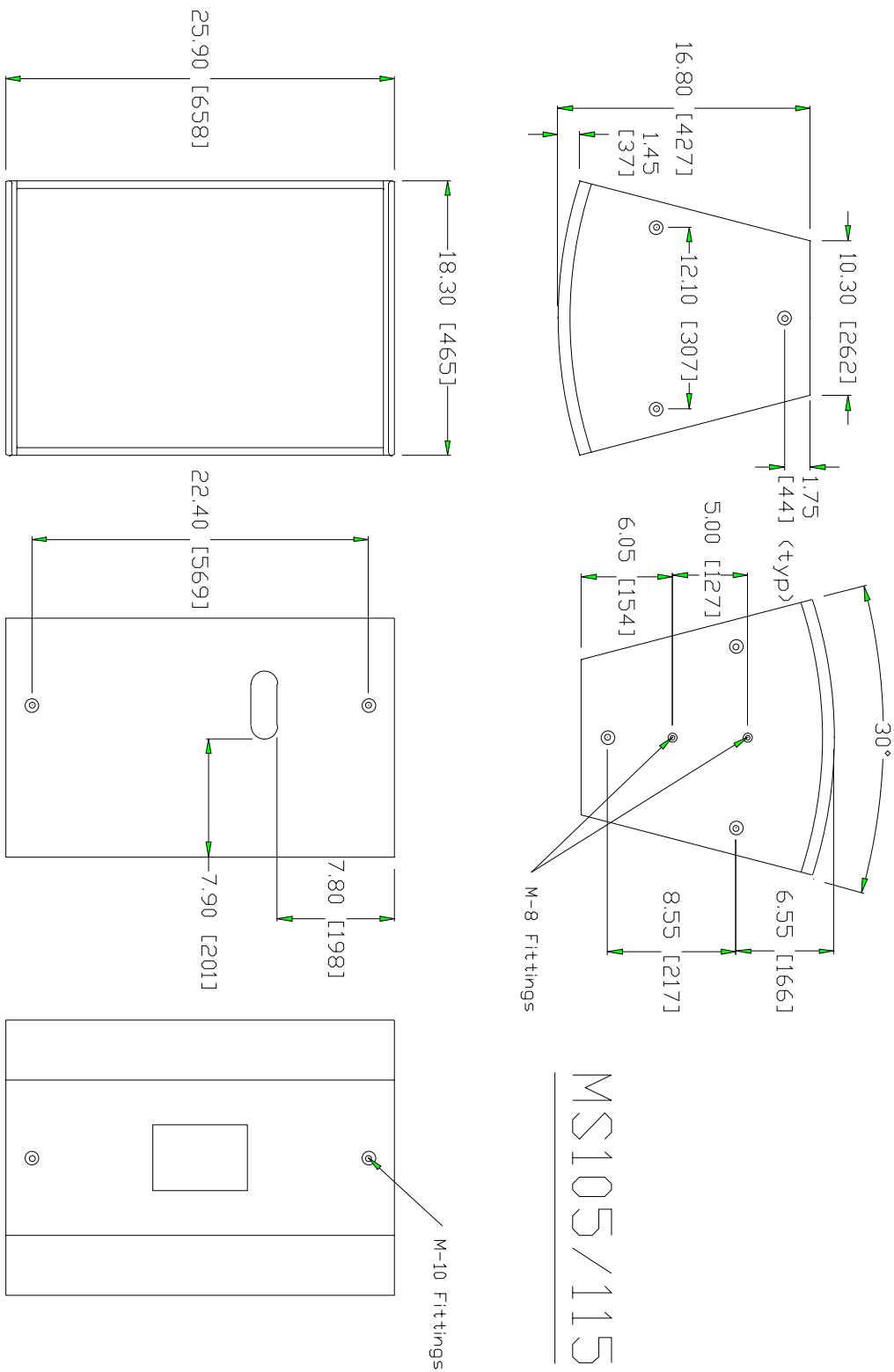

\* **Important!** Dimensions are in inches [millimeters]. Please note that all measurements are OD (outside dimensions). Due to the nature of construction and the DuraFlex™ finish, all measurements may vary ± 0.039 in (± 1 mm).

# MS112

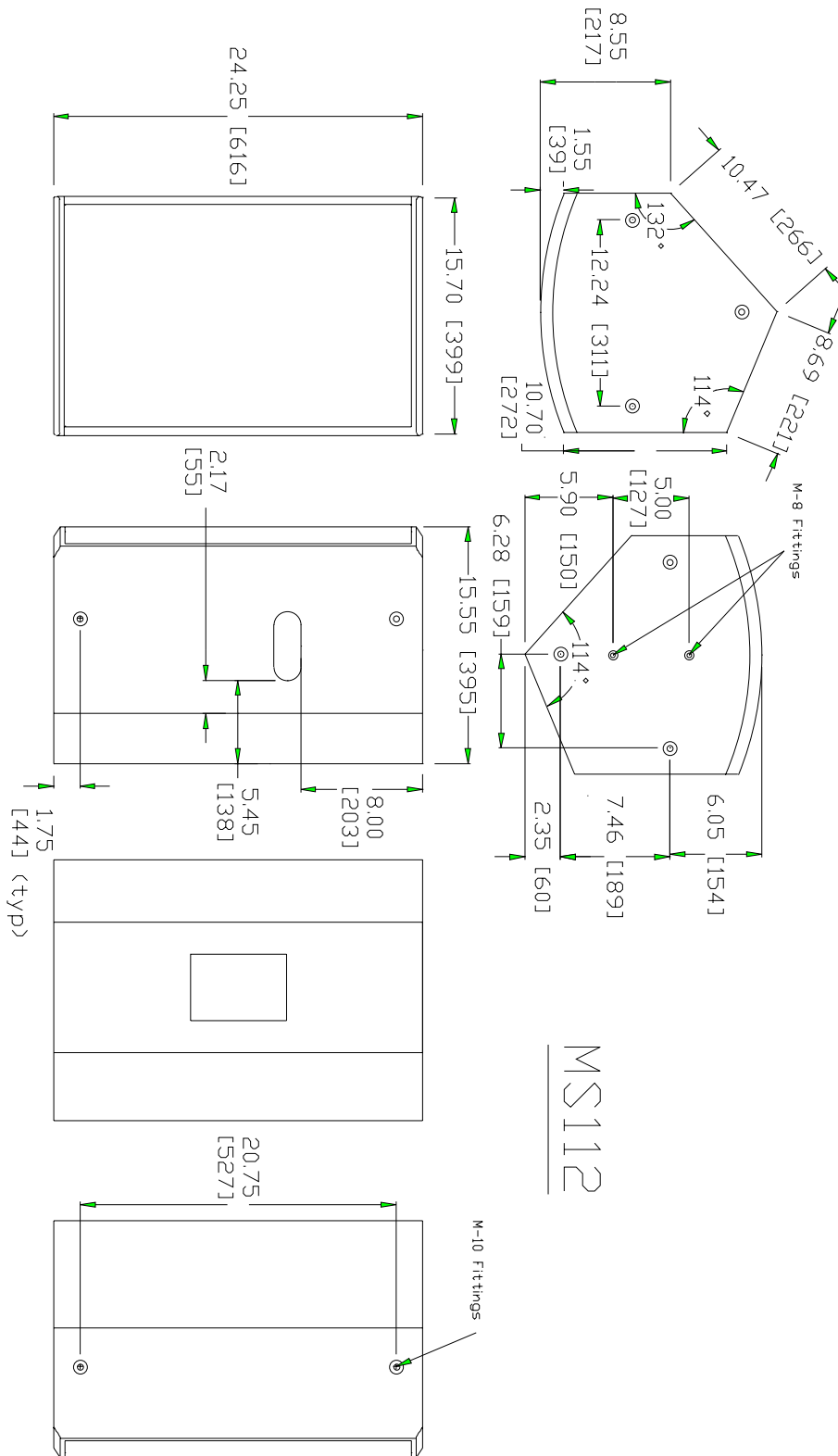

MS112

\* *Important!* Dimensions are in inches [millimeters]. Please note that all measurements are OD (outside dimensions). Due to the nature of construction and the DuraFlex™ finish, all measurements may vary ± 0.039 in (± 1 mm).

# MS125S

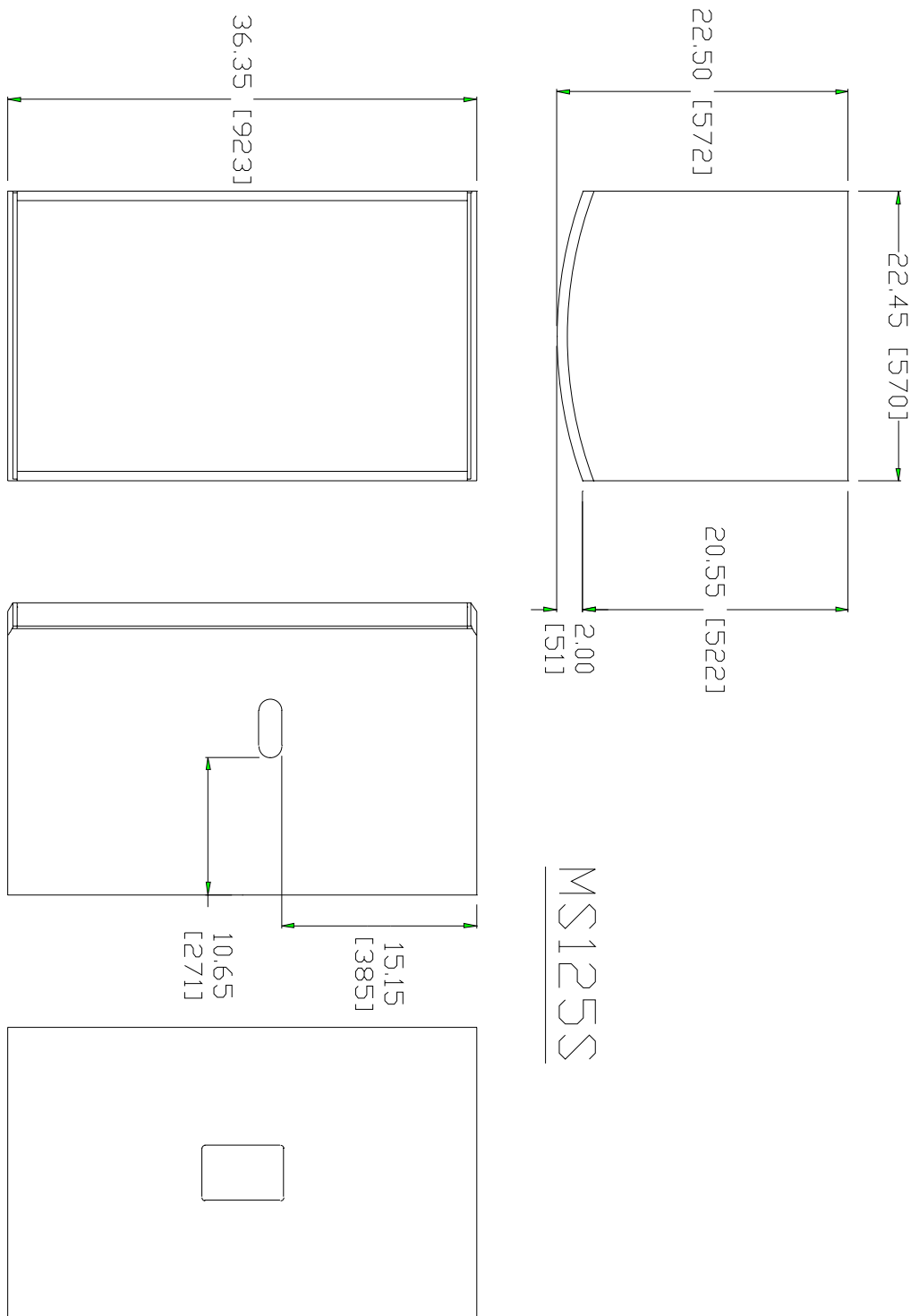

# MS125S

\* *Important!* Dimensions are in inches [millimeters]. Please note that all measurements are OD (outside dimensions). Due to the nature of construction and the DuraFlex™ finish, all measurements may vary ± 0.039 in (± 1 mm).





# SP222

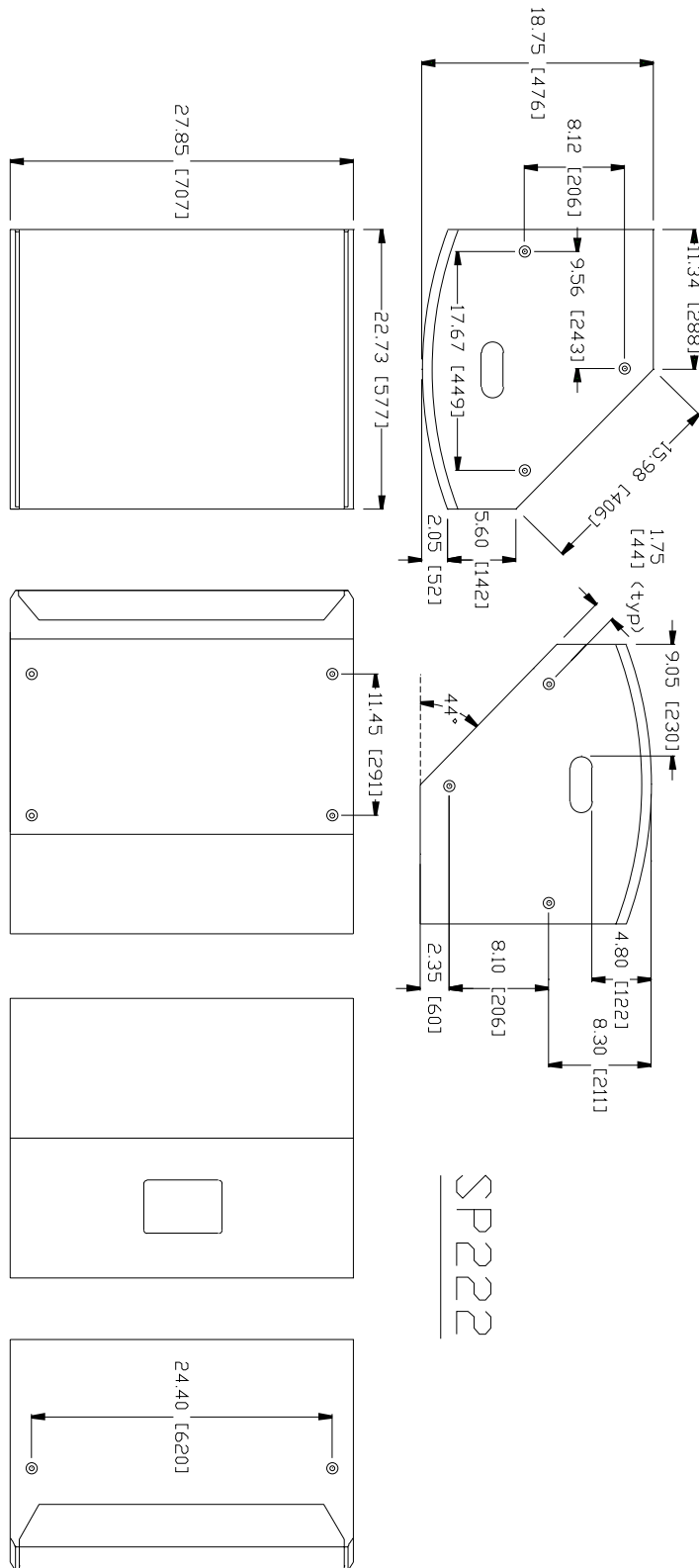

SP222

\* **Important!** Dimensions are in inches [millimeters]. Please note that all measurements are OD (outside dimensions). Due to the nature of construction and the DuraFlex™ finish, all measurements may vary ± 0.039 in (± 1 mm).

# SP215-6, SP215-9

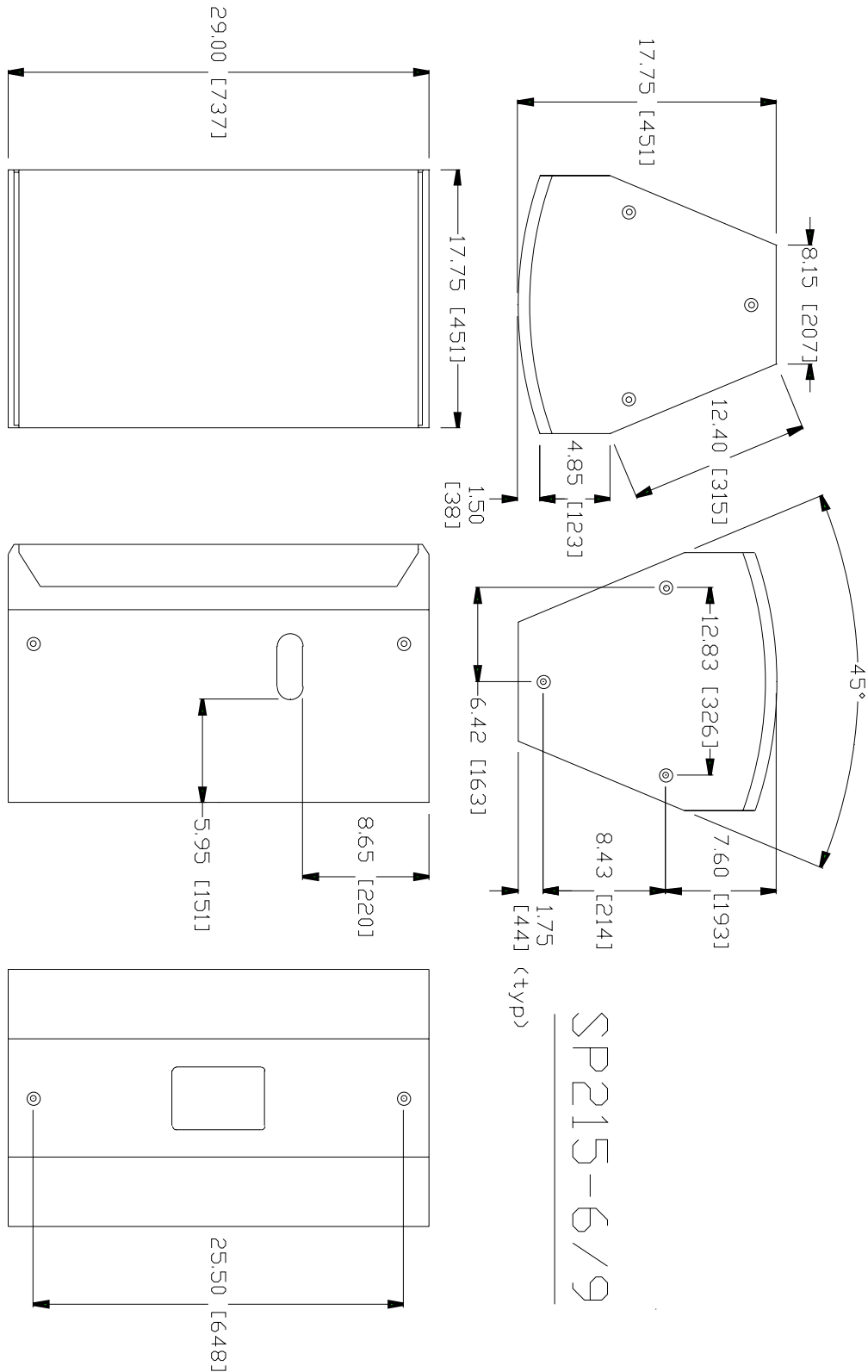

\* *Important!* Dimensions are in inches [millimeters]. Please note that all measurements are OD (outside dimensions). Due to the nature of construction and the DuraFlex™ finish, all measurements may vary ± 0.039 in (± 1 mm).

# SP225-6, SP225-9

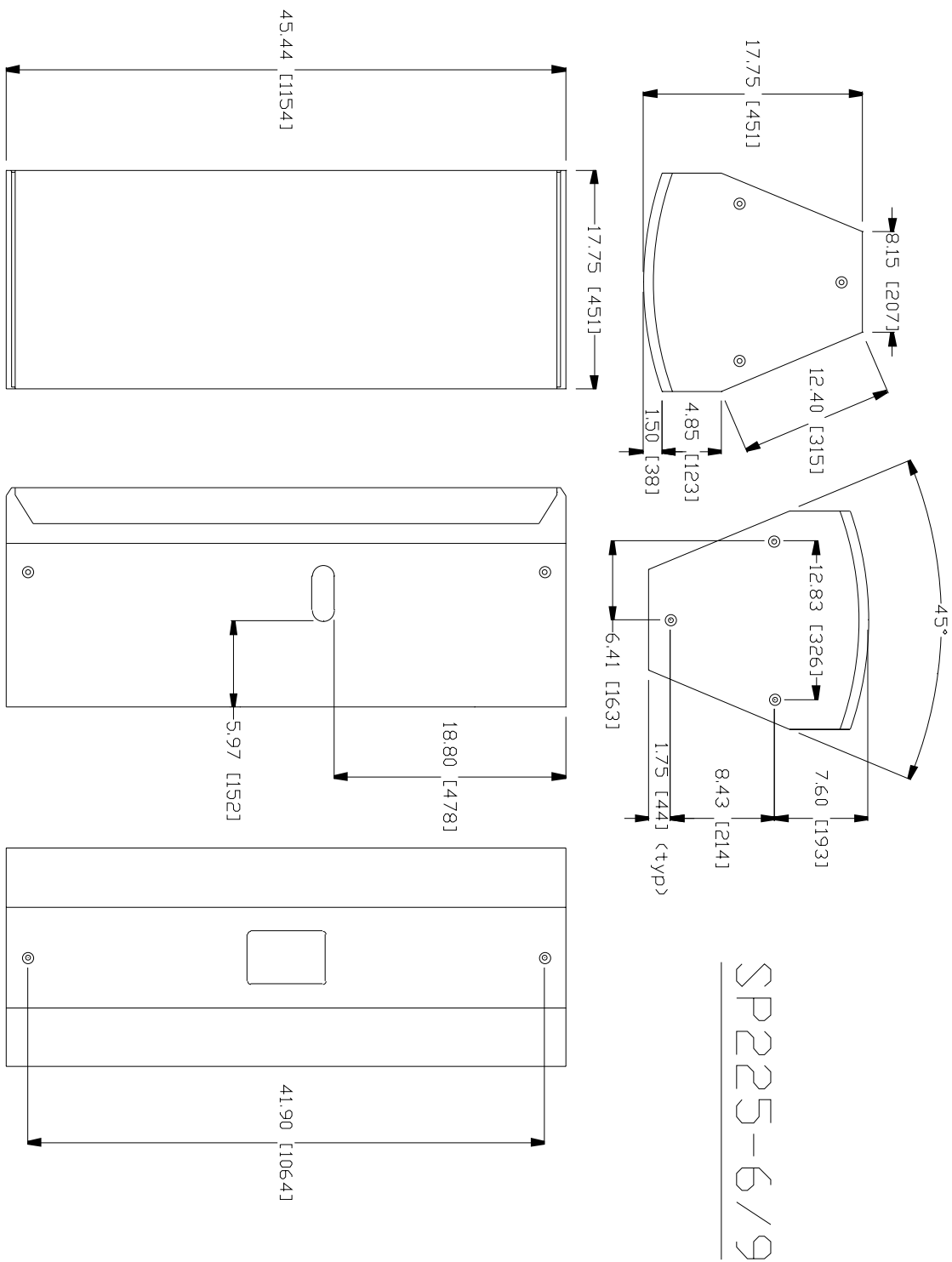

\* **Important!** Dimensions are in inches [millimeters]. Please note that all measurements are OD (outside dimensions). Due to the nature of construction and the DuraFlex™ finish, all measurements may vary ± 0.039 in (± 1 mm).

# SP125S

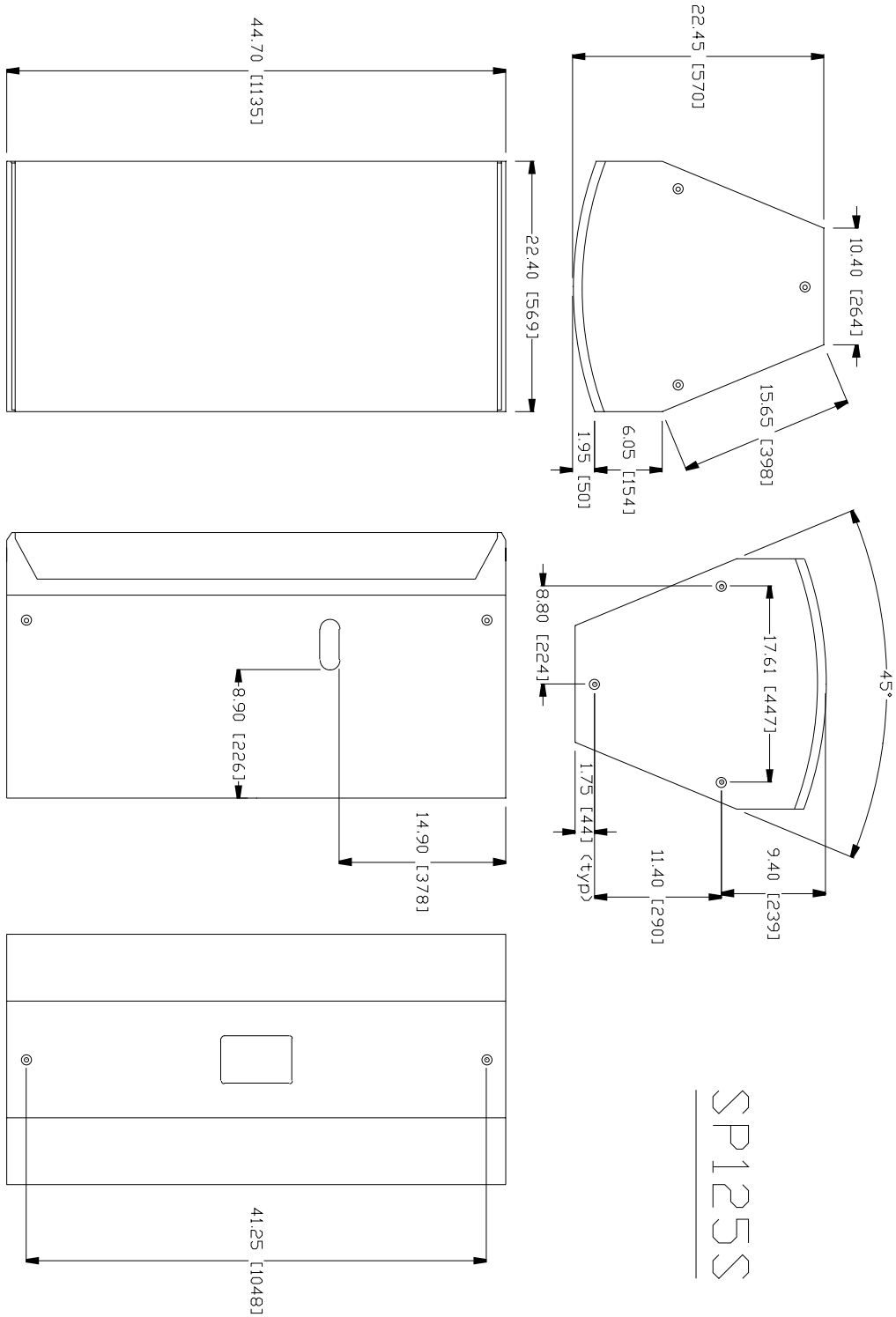

SP125S

\* *Important!* Dimensions are in inches [millimeters]. Please note that all measurements are OD (outside dimensions). Due to the nature of construction and the DuraFlex™ finish, all measurements may vary ± 0.039 in (± 1 mm).

# SP128S

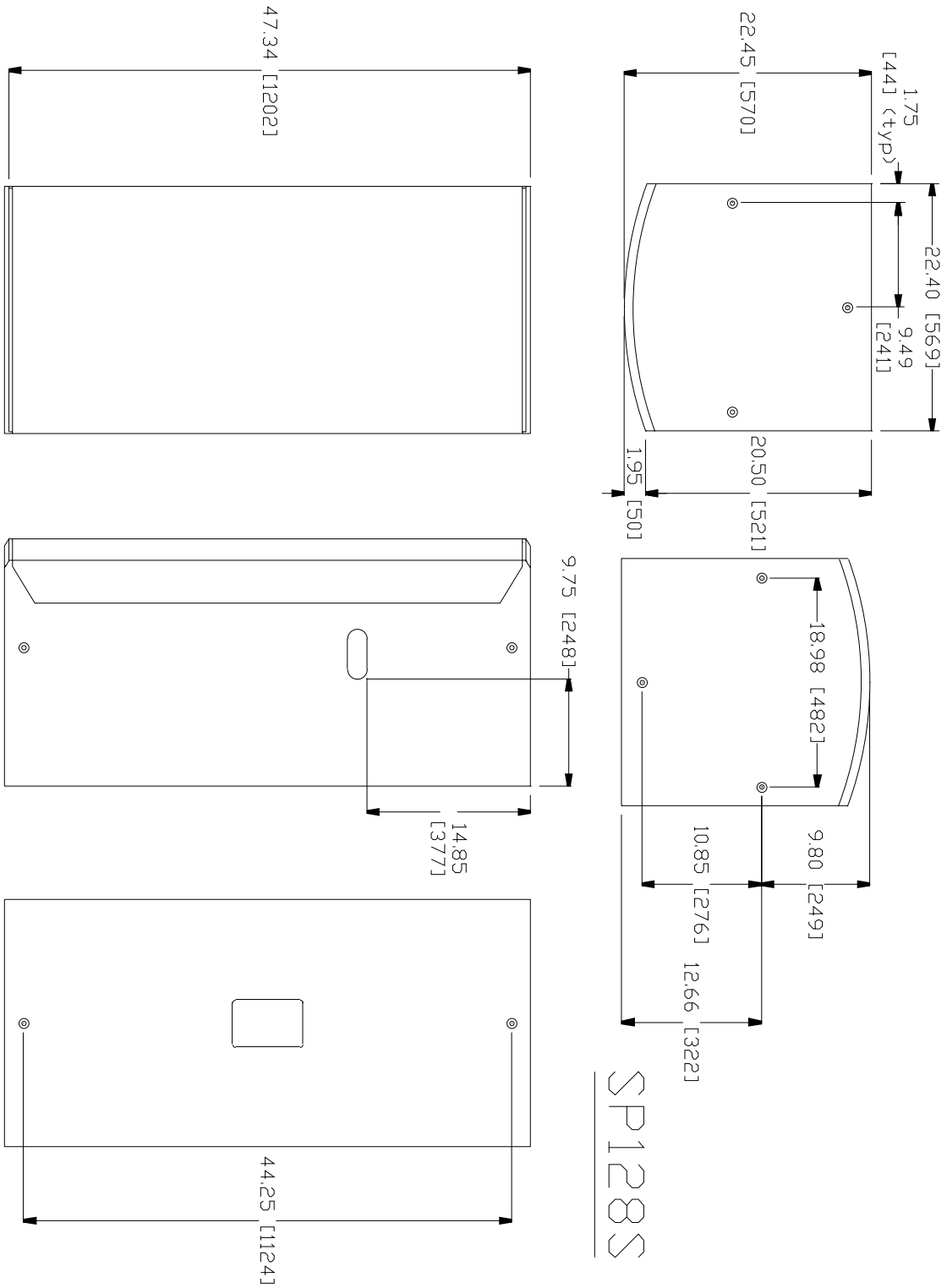

SP128S

\* **Important!** Dimensions are in inches [millimeters]. Please note that all measurements are OD (outside dimensions). Due to the nature of construction and the DuraFlex™ finish, all measurements may vary ± 0.039 in (± 1 mm).



# VS2110

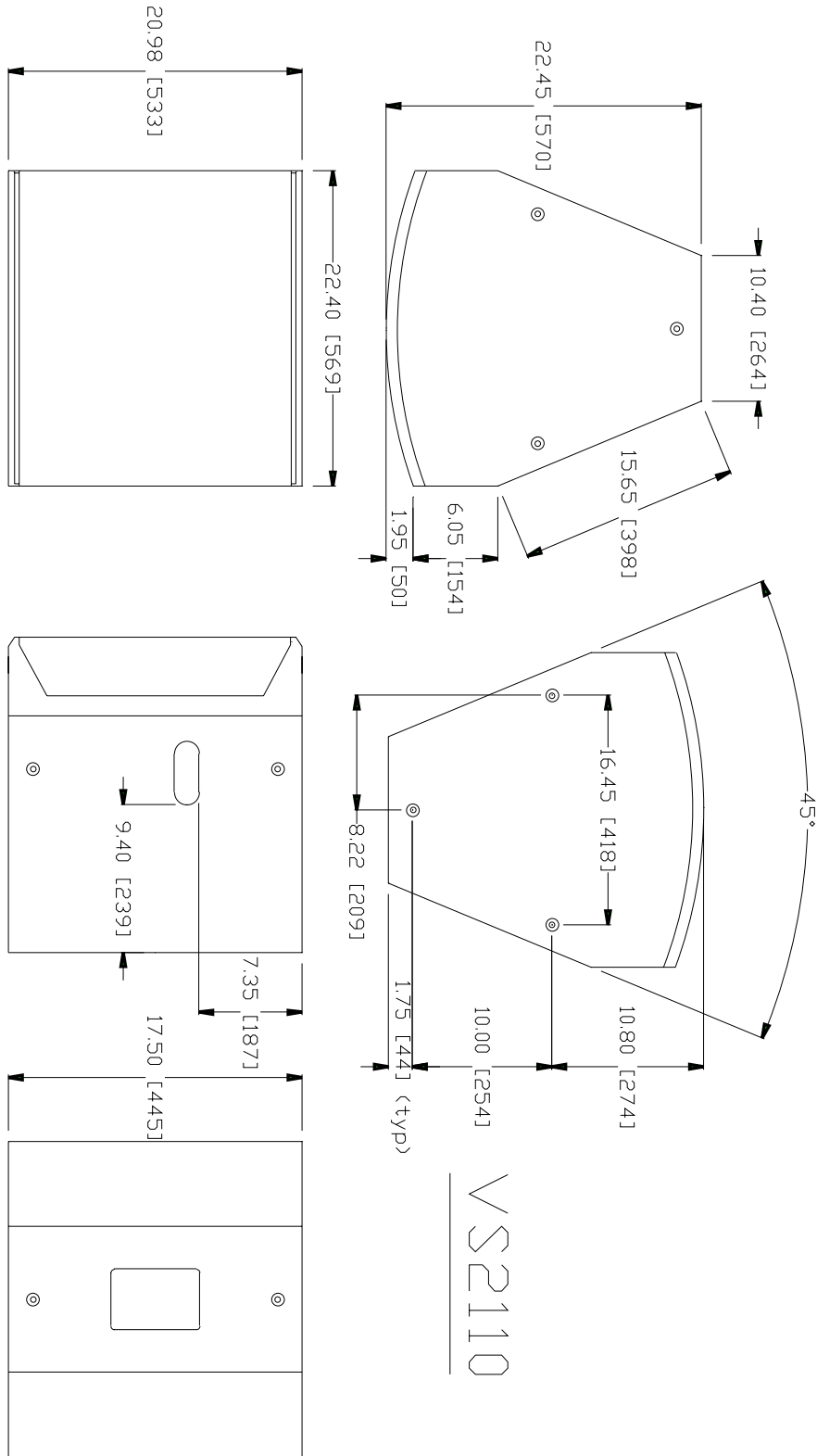

# VS2110

\* *Important!* Dimensions are in inches [millimeters]. Please note that all measurements are OD (outside dimensions). Due to the nature of construction and the DuraFlex™ finish, all measurements may vary ± 0.039 in (± 1 mm).

# VS2210-6, VS2210-9

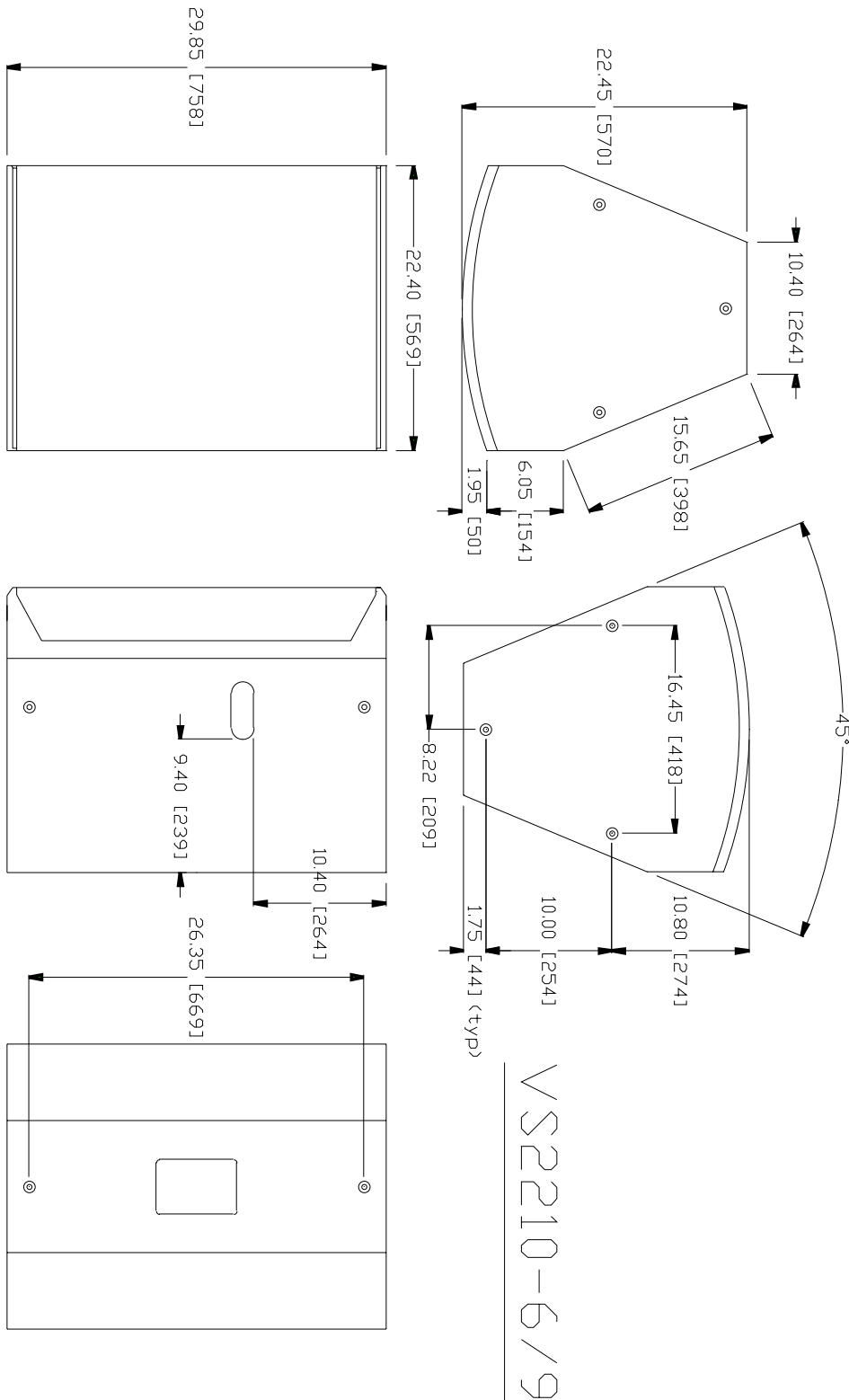

\* *Important!* Dimensions are in inches [millimeters]. Please note that all measurements are OD (outside dimensions). Due to the nature of construction and the DuraFlex™ finish, all measurements may vary ± 0.039 in (± 1 mm).



# VS3115

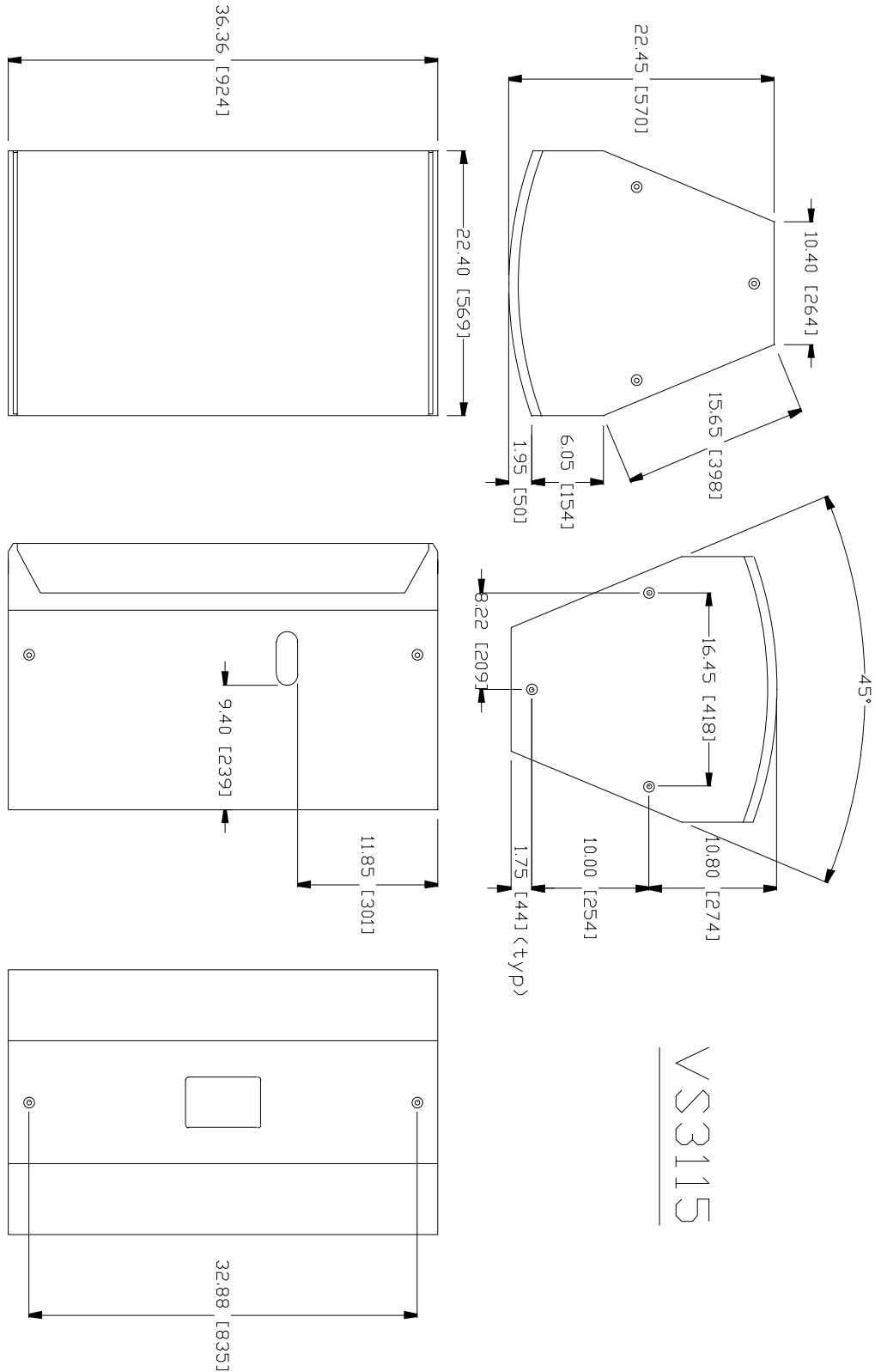

VS3115

\* *Important!* Dimensions are in inches [millimeters]. Please note that all measurements are OD (outside dimensions). Due to the nature of construction and the DuraFlex™ finish, all measurements may vary ± 0.039 in (± 1 mm).

VS3215-6, VS3215-9

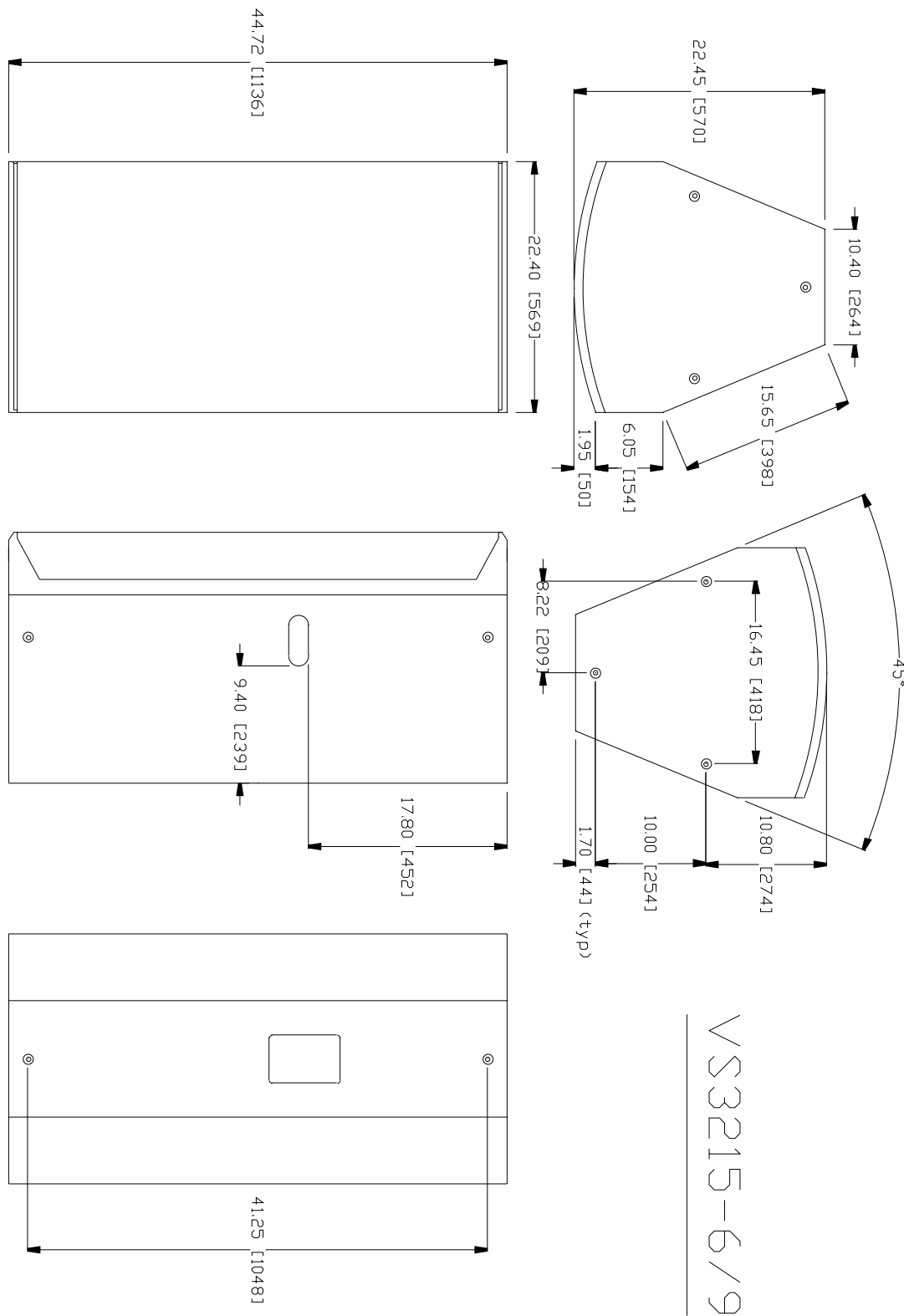

\* *Important!* Dimensions are in inches [millimeters]. Please note that all measurements are OD (outside dimensions). Due to the nature of construction and the DuraFlex™ finish, all measurements may vary ± 0.039 in (± 1 mm).

# VS3218-6, VS3218-9

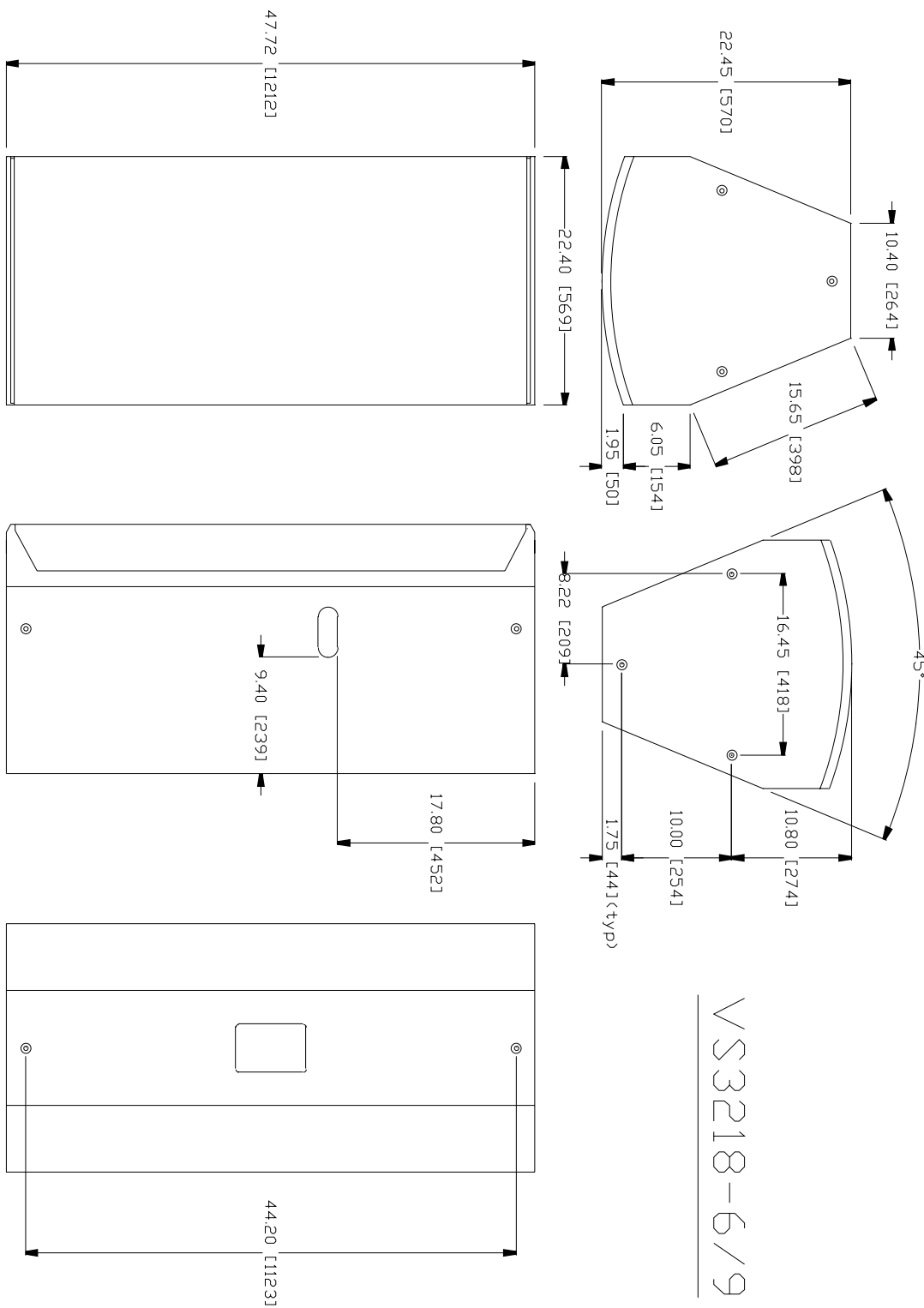

\* *Important!* Dimensions are in inches [millimeters]. Please note that all measurements are OD (outside dimensions). Due to the nature of construction and the DuraFlex™ finish, all measurements may vary ± 0.039 in (± 1 mm).

# VS125HS

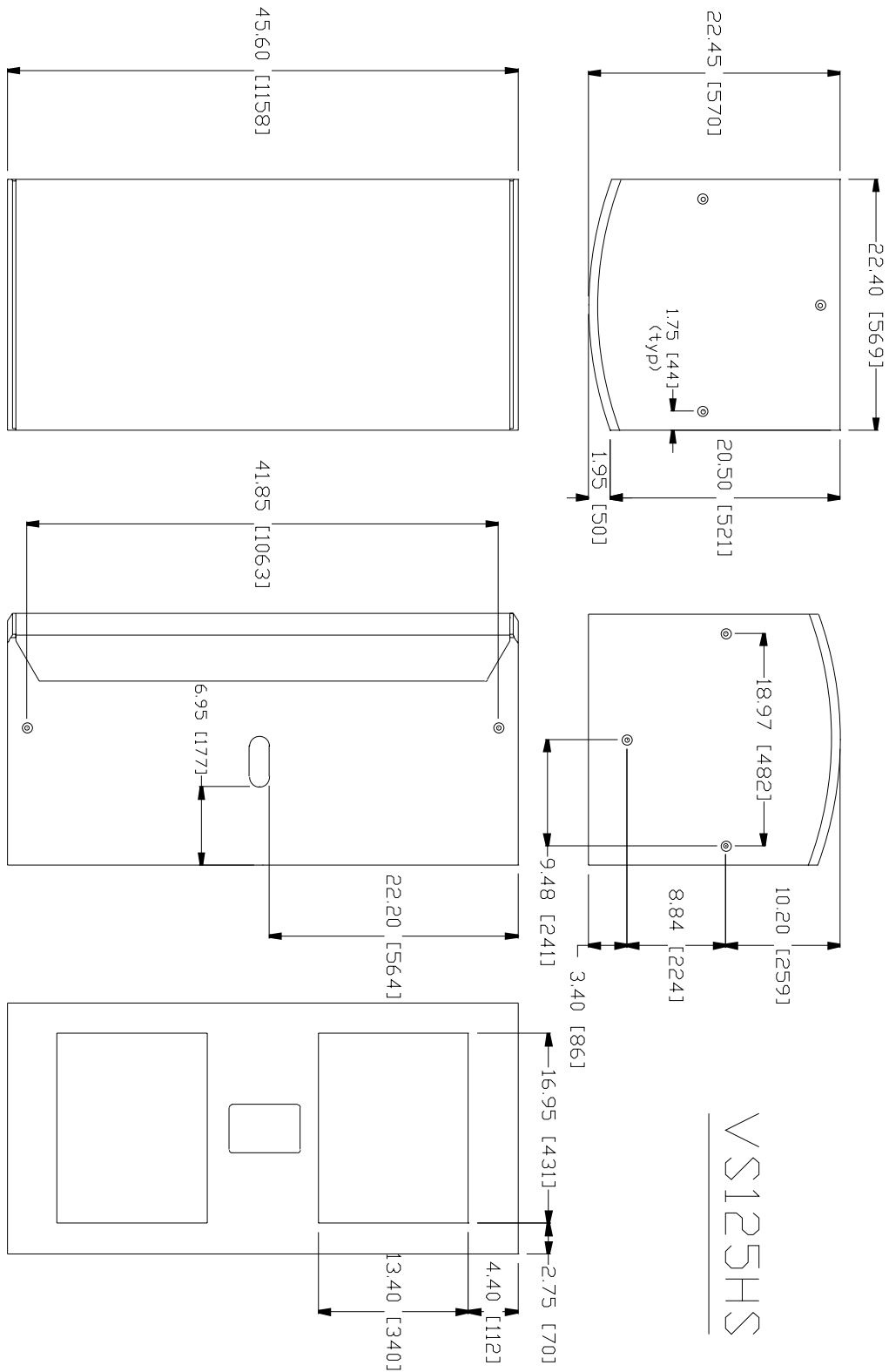

\* **Important!** Dimensions are in inches [millimeters]. Please note that all measurements are OD (outside dimensions). Due to the nature of construction and the DuraFlex™ finish, all measurements may vary ± 0.039 in (± 1 mm).



Notes



8500 Balboa Blvd.  
Northridge, CA 91329  
Tel: (818) 894-8850  
[www.jblpro.com](http://www.jblpro.com)

**H** A Harman International Company

Part # WP INSTALL DRAW

rev. A  
08/99