

### Features:

- Stage monitors, side-fill and P.A. applications.
- Compact size, flat front.
- Aluminum exponential horn.
- 25 mm (1") throat.
- 90°(H) x 60°(V) nominal coverage.



### SPECIFICATIONS

|  |               |         |
|--|---------------|---------|
| Nominal coverage                           |               |         |
| Horizontal                                 | 90            | degrees |
| Vertical                                   | 60            | degrees |
| Directivity                                |               |         |
| Directivity factor (Q)                     | 9             |         |
| Directivity index (Di)                     | 9             | dB      |
| Sensitivity                                |               |         |
| On driver, 1W @ 1m, on axis <sup>1</sup>   | 106           | dB SPL  |
| Frequency response @ -10 dB <sup>2</sup>   | 800 to 18,000 | Hz      |
| Throat diameter                            | 25 (1)        | mm (in) |
| Minimum recommended crossover <sup>3</sup> | 1,200         | Hz      |

<sup>1</sup> Measured with D205TI driver, 1,200 - 3,000 Hz average.

<sup>2</sup> Measured with D205TI driver.

<sup>3</sup> With D205TI driver.

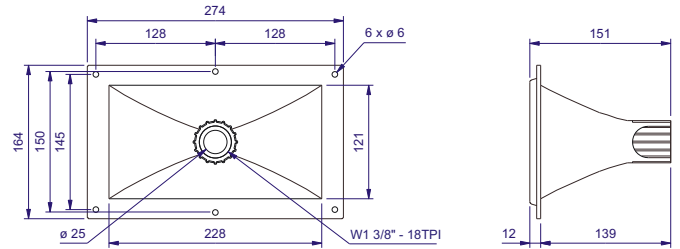

Dimensions in mm.

### ADDITIONAL INFORMATION

|                               |   |
|-------------------------------|---|
| Horn material                 | Aluminum                                |
| Horn finish                   | Black epoxy                             |
| Overall dimensions            |   |
| Mouth height                  | 164 (6.46) mm (in)                      |
| Mouth width                   | 274 (10.79) mm (in)                     |
| Length                        | 151 (5.95) mm (in)                      |
| Volume displaced by horn      | 1.2 (0.04) l (ft <sup>3</sup> )         |
| Net weight                    | 810 (1.79) g (lb)                       |
| Gross weight                  | 980 (2.16) g (lb)                       |
| Carton dimensions (W x D x H) | 17 x 17 x 28 (6.7 x 6.7 x 11.0) cm (in) |

### MOUNTING INFORMATION

|  |   |
|--|---|
| Mechanical connection of driver        | Screw-on 1 <sup>3</sup> / <sub>8</sub> " - 18 TPI |
| Baffle cutout dimensions (front mount) |   |
| Horizontal                             | 235 (9.25) mm (in)                                |
| Vertical                               | 125 (4.92) mm (in)                                |

### HORN x DRIVER CONNECTION

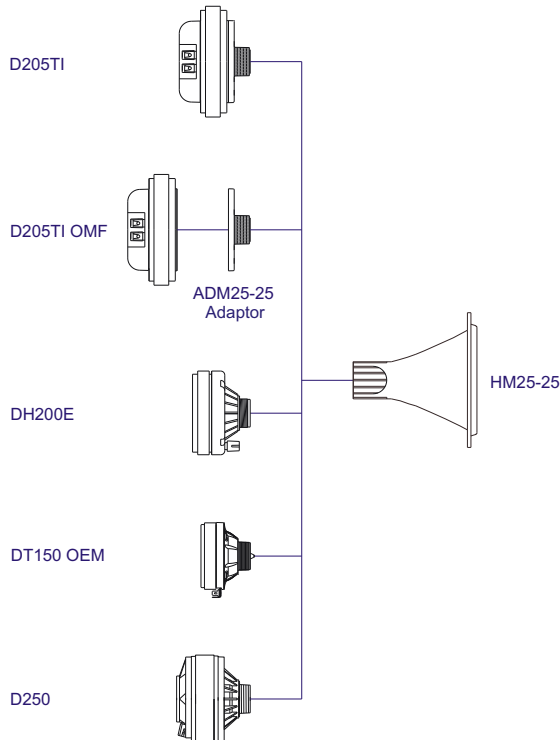

### RESPONSE AND IMPEDANCE CURVES W/ D205TI DRIVER INSIDE AN ANECHOIC CHAMBER, 1 W / 1 m

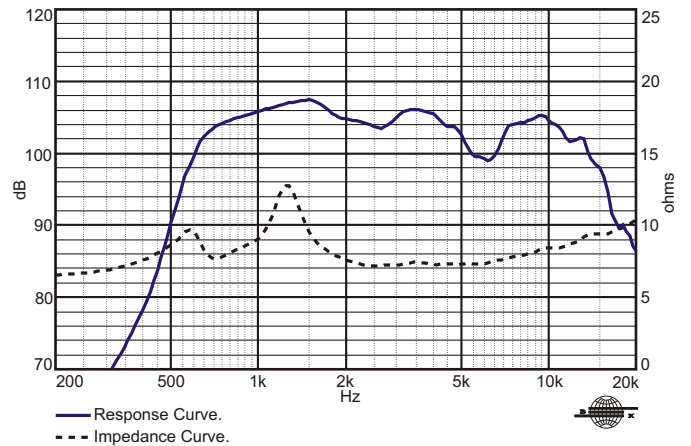

### POLAR RESPONSE CURVE

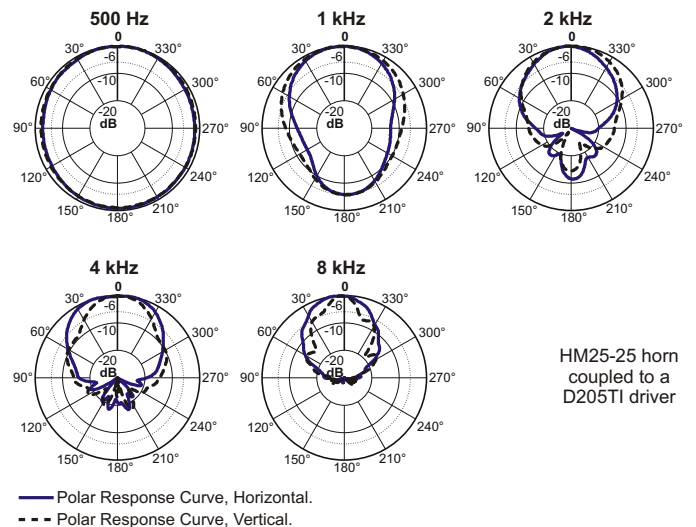

HM25-25 horn coupled to a D205TI driver