

THESE DRAWINGS AND SPECIFICATIONS ARE THE PROPERTY OF JBL INCORPORATED. THEY ARE ISSUED IN STRICT CONFIDENCE AND SHALL NOT BE REPRODUCED OR USED AS THE BASIS FOR MANUFACTURE OR APPARATUS WITHOUT WRITTEN PERMISSION.

ALL MATERIAL SPECIFIED ON THIS DRAWING SHALL COMPLY WITH EUROPEAN DIRECTIVE 2002/95/EC. **RoHS**

REVISIONS					
CHG	LTR	DESCRIPTION	DRFT	D.C.	DATE
00648	A	RELEASE TO MARKETING	TH		11/14/06

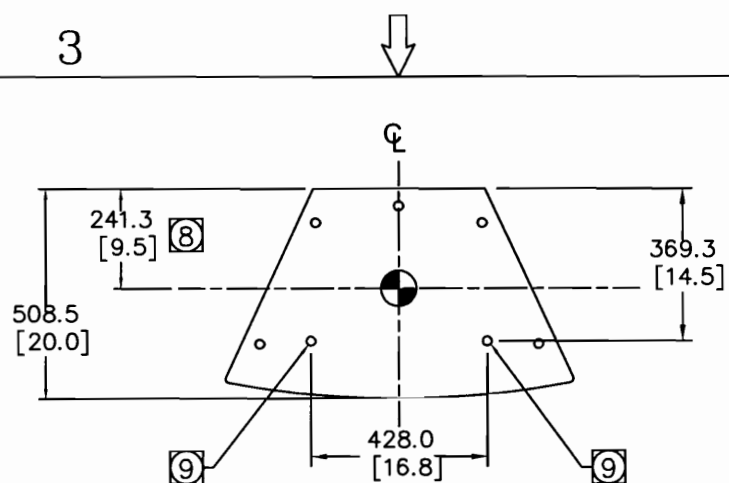

TOP

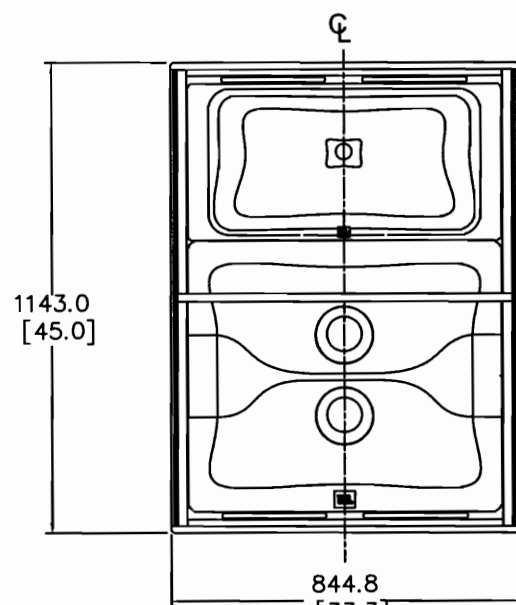

FRONT

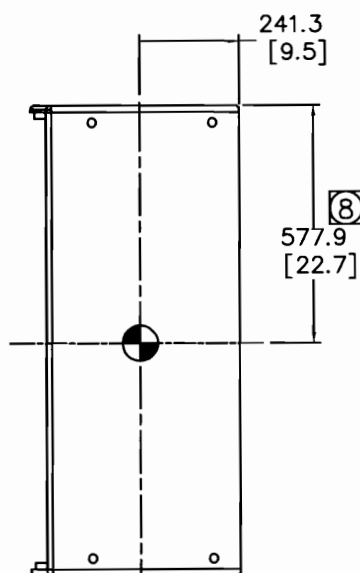

SIDES

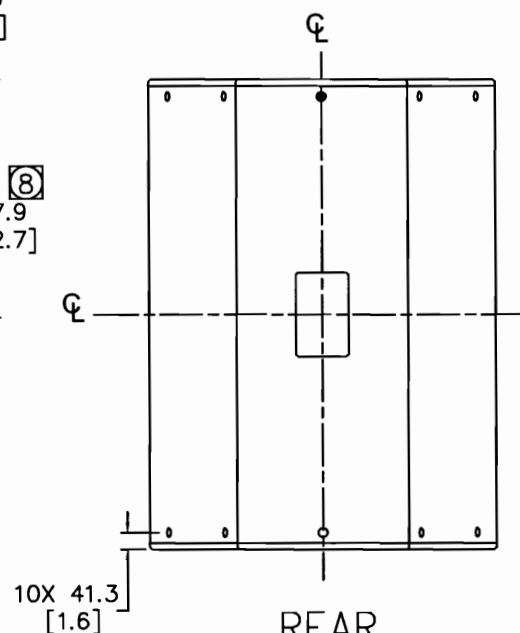

REAR

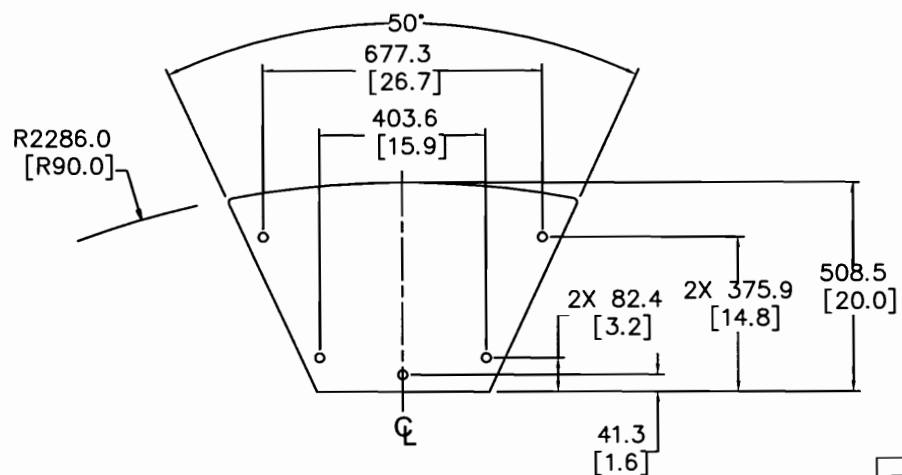

BOTTOM

⑨ STACKING BRACKETS POINTS:
M10 THREADED NUT PLATES, 2X TO AS INDICATED.
NOT TO BE USED FOR OVERHEAD SUSPENSION.

⑧ INDICATED DIMENSIONS ARE TO
CENTER OF GRAVITY (CG)

7. WEIGHT: 52.2 Kg (115.0 LBS).

6. SUSPENSION POINTS: M10 THREADED SUSPENSION
POINTS. 5X TOP, 5X BOTTOM, 2X REAR,
4 LEFT SIDE, 4 RIGHT SIDE.

5. COMPONENTS: MF - 2X 2169H
HF - 1X 2453H-SL

4. INPUT CONNECTORS: NEUTRIK NL4 IN
PARALLEL WITH 4 POSITION TERMINAL
STRIP.

3. GRILLE: 14 GA. PERFORATED CRS, POWDERCOATED.
BLACK.

2. MATERIALS: 15.8 MM BIRCH PLYWOOD.

1. FINISH: BLACK DURAFLEX

NOTES: (UNLESS OTHERWISE SPECIFIED)

TOLERANCES
(UNLESS OTHERWISE SPECIFIED)
X.XX ± .063 INCH
X.X ± .125 INCH
ANGULAR TOLERANCE OF 0°±30°
FRACTIONAL DIMENSIONS ± 1/32
• DIMENSIONS ARE INCHES
• ALL DIMENSIONS ARE FINISHED DIMENSIONS
• DO NOT SCALE DRAWING

JBL JBL PROFESSIONAL
A Harman International Company
Northridge, California 91329 U.S.A.

TITLE		
CUSTOMER DRAWING: MD2		
SIZE	DRAWING NO.	REV
A	446325	A
SCALE		SHEET
NTS		1 OF 1