

THESE DRAWINGS AND SPECIFICATIONS ARE THE PROPERTY OF JBL INCORPORATED. THEY ARE ISSUED IN STRICT CONFIDENCE AND SHALL NOT BE REPRODUCED OR USED AS THE BASIS FOR MANUFACTURE OR APPARATUS WITHOUT WRITTEN PERMISSION.

ALL MATERIAL SPECIFIED ON THIS DRAWING SHALL COMPLY WITH EUROPEAN DIRECTIVE 2002/95/EC. **RoHS**

REVISIONS						
CHG	LTR	DESCRIPTION	DEFT	D.C	DATE	APPR
40000	A	RELEASE TO MARKETING	TH			
00648	B	UPD POLE MT. CG LOCATION AND REVISE NOTES	TH		11/17/11	CA

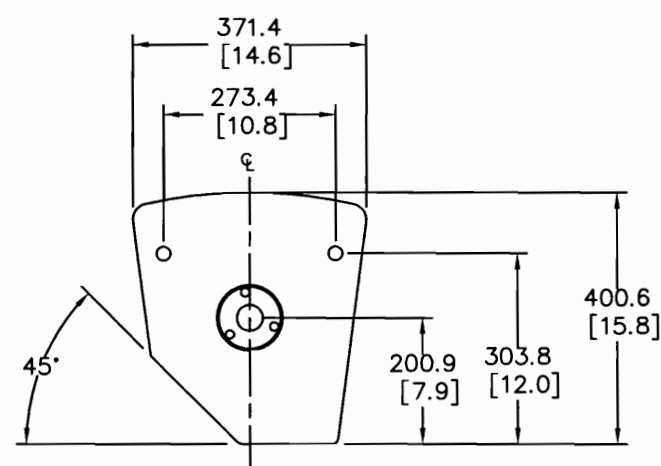
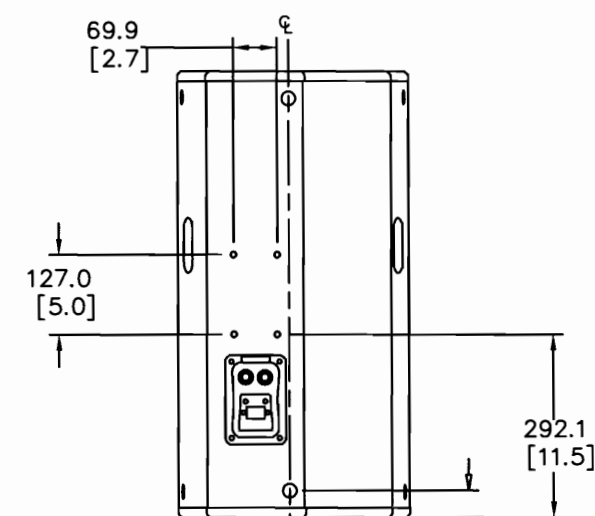
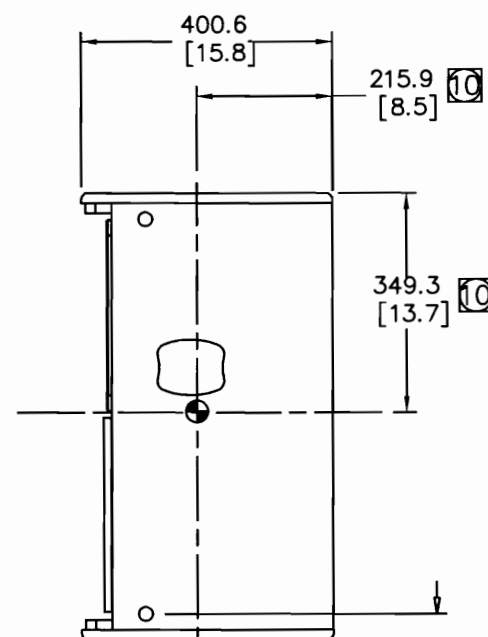
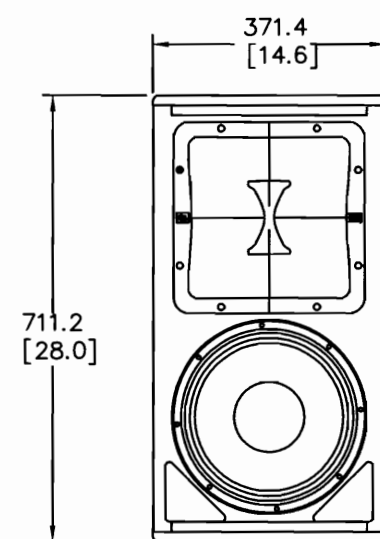
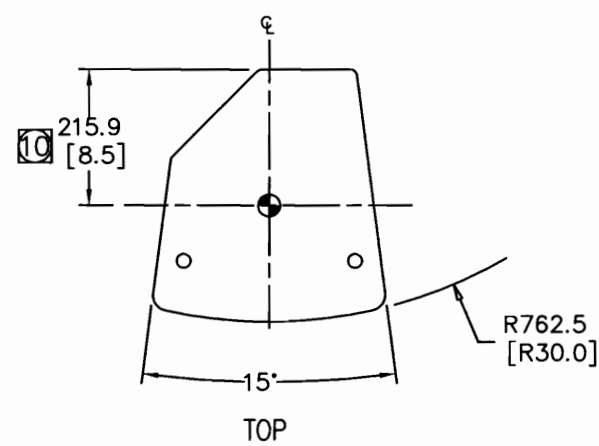

INDICATED DIMENSIONS ARE TO CENTER OF GRAVITY (CG)

- WEIGHT: 20.6 Kg(45.5 LBS).
- SUSPENSION POINTS: M10 - THREADED SUSPENSION POINTS. 2X TOP, 2X BOTTOM, 2X LEFT, 2X RIGHT, 2X REAR
- M8 - THREADED SUSPENSION POINTS. 4X REAR FOR OMNIMOUNT 60.0.
- POLE MOUNT: 35mm (1-3/8") FEMALE SOCKET.
- COMPONENTS: LF - 262H-1  
HF - 2408H-1
- INPUT CONNECTORS: 2 NEUTRIK NL4 AND 1 BARRIER STRIP WITH 2 TERMINALS, ALL 3 CONNECTED IN PARALLEL.
- GRILL: 14 GA. PERFORATED CRS, POWDER COATED BLACK.
- MATERIALS: 15.8 MM BIRCH PLYWOOD.
- FINISH: BLACK DURAFLEX

NOTES: (UNLESS OTHERWISE SPECIFIED)

**TOLERANCES**  
(UNLESS OTHERWISE SPECIFIED)

XXX ± .063 INCH  
XX ± .125 INCH  
ANGULAR TOLERANCE OF 0°±30°  
FRACTIONAL DIMENSIONS ± 1/32

\* DIMENSIONS ARE INCHES  
\* ALL DIMENSIONS ARE FINISHED DIMENSIONS  
\* DO NOT SCALE DRAWING

JBL PROFESSIONAL A Harman International Company Northridge, California 91329 U.S.A.		
TITLE CUSTOMER DRAWING: MD52		
SIZE A	DRAWING NO. 446233	REV B
SCALE NTS	SHEET 1 OF 1	