

THESE DRAWINGS AND SPECIFICATIONS ARE THE PROPERTY OF JBL, INCORPORATED. NO PARTS OR SUBASSEMBLIES SHALL BE REPRODUCED OR USED IN ANY MANNER WITHOUT THE WRITTEN PERMISSION OF JBL, INCORPORATED.

ALL DIMENSIONS SHOWN ON THIS DRAWING SHALL COMPLY WITH THE DIMENSIONAL ACCURACY SPECIFICATIONS OF THE JBL DRAWING DIMENSIONAL ACCURACY SPECIFICATIONS (JBL.DIM.ACCURACY.SPEC). [23]

REVISIONS			
DATE	DESCRIPTION	BY	DATE
07/23/14	RELEASE TO MARKETING	TH	

4

3

2

1

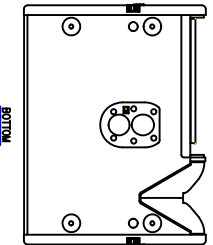
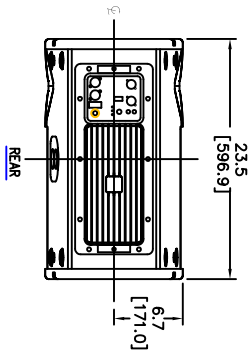
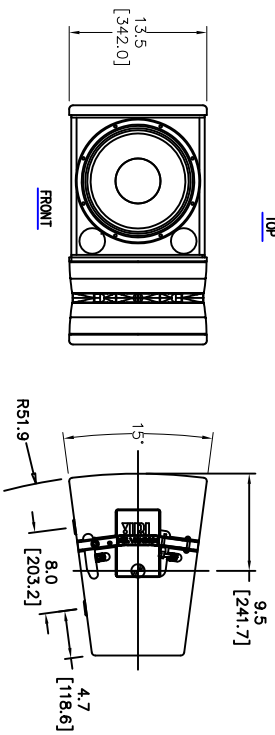
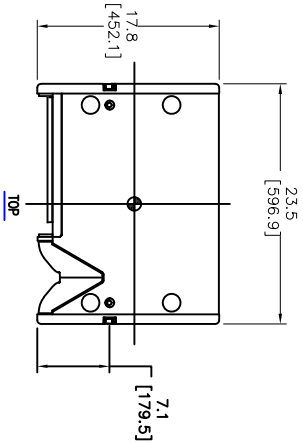

1. COMPONENTS: LF - 1X 2262FF; HF - 3X 2408U.
2. INPUT CONNECTORS: XLR WITH LOOP THRU.
3. GRILL: 16 GA. PERFORATED CRS. POWDER COATED BLACK WITH BLACK FOAM BACKING.
4. MATERIALS: 15MM FINISH BIRCH PLYWOOD
6. POLE MOUNT 35mm (1-3/8") FEMALE SOCKET, 0° AND 15° AIMING ANGLES.
7. WHITE (-WH) MODEL DOES NOT INCLUDE HANDLE OR POLE MOUNT.
8. RIGGING SYSTEM: INTEGRATED RIGGING HARDWARE TO CONNECT MULTIPLE VRX932LAP ENCLOSURES, VRX918SP SUBWOOFERS AND ACCESSORY ARRAY FRAME.

TOLERANCES (UNLESS OTHERWISE SPECIFIED)	
XX	± .003 INCH
XX	± .015 INCH
MINOR TOLERANCE OF .003"	

JBL PROFESSIONAL	
A Harman International Company Northridge, California 91329 U.S.A.	
TITLE	
CUSTOMER DRAWING: VRX932LAP	