

# CMX6903

## Column Array Loudspeaker



JBL CMX6903 Column Array Loudspeaker is part of the JBL CMX series professional loudspeaker family designed for fixed-installation. It is great for conference rooms, home audio and outdoor squares as a standalone PA system, or a part of broadcast system cooperating with CMX6208SP. It brings the legendary sound quality performance of JBL to support the needs of presenters looking for a premium PA column speaker system.

The JBL CMX6903 is a simple solution for spaces that require integrated audio/video presentation systems. The CMS loudspeaker system can be used in conjunction with many other JBL and Harman products to produce a multi functional and cost-effective complete AV system.

### Packing List

CMX6903 loudspeaker	x1
Waterproof plug	x1
Instructions	x1
M8 hanger ring	x1
M8 spacers	x4
M8 waterproof gaskets	x4
Vertical installation support	x1
CMX Base*	x1

\*Used with the CMX6208SP

### Product Highlights

#### Outstanding sound quality

Engineered by the team that created the legendary JBL sound, the CMX6903 delivers bright, clear high frequency sound with precise mid and low frequency rendering for exceptional audio clarity. Its wide coverage angle means it is perfect for small and large spaces alike.

#### Flexible installation

Vertical installation structure design for easy installation in different application environments, CMX6903 can be top-mounted and powered by CMX6208SP active subwoofer to form a standalone portable PA system. Replacement of the bottom with CMX cover plate can make CMX6903 wall-mounted and beautiful.

#### Reliable performance

Designed for durability over the long term, the JBL CMX6903 has been rigorously tested to ensure years of high quality, dependable operation. Featuring aluminum cabinet, CMX6903 is well sealed. Nylon mesh is added in the iron mesh to effectively protect CMX6903 drivers and ensure normal operation in harsh environment.

### Main Features

#### Vocal Clarity

Tuned for speech intelligibility, JBL CMX6903 employs legendary JBL loudspeaker technology to provide clear, crisp and consistent sound rendering particularly in the vocal range, perfect for speeches, meetings and presentations.

#### High ROI

JBL CMX6903 Column Loudspeaker is designed deliver quality audio at a price that maximizes the return on investment.

### Application Scope

Public speaking environments   Classrooms   Conference rooms  
Small speech places   Outdoor sound amplification  
Monitor sound amplification

### Specifications

Frequency range (-10dB)	100Hz-18kHz
Frequency response ( $\pm 3$ dB)	110Hz-17kHz
Coverage angle (H x V)	110°x40°
Rated power <sup>1</sup>	300W/600W/1,200W (continuous/program/peak)
Max peak SPL (2 $\pi$ )	127dB (SPL)
Sensitivity (4 $\pi$ )	92dB
Bass unit	9x84 mm (3.3 inch) carbon fiber bass loudspeaker
Treble unit	2x34 mm (1.3 inch) compression driven treble unit
Rated impedance	8 ohms
Box structure	Full aluminum alloy enclosure, black powder coating
Grille	Black powder coating, 4*4mm hexagonal mesh back cover Acoustic transmission screen cloth, waterproof acoustic transmission screen cloth
Input connector	2-core waterproof socket M22-2P, XT60H-M
Dimensions (H x W x D)	1,242 x 127 x 161 mm (48.9 x 5 x 6.3 inch)
Net weight	14 kg (30.9 lbs)

<sup>1</sup> Test for 2 hours under the condition of IEC standard and pink noise with crest factor equal to 6 dB.

# CMX6903

## Column Array Loudspeaker



### Frequency Response Curve ■

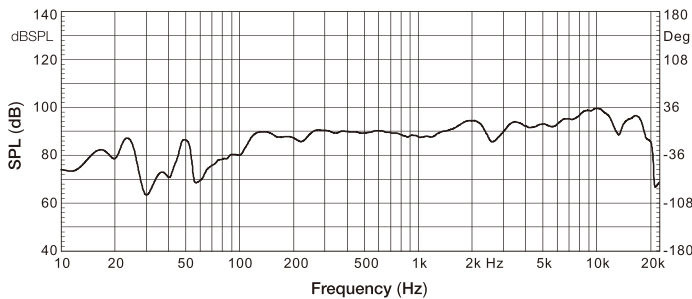

### HxV Scope Curve ■

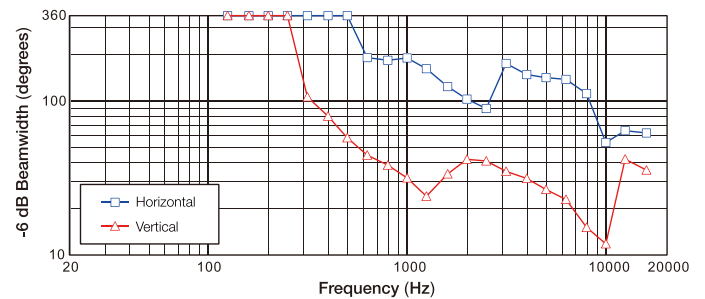

### Installation Modes ■

#### Vertical installation

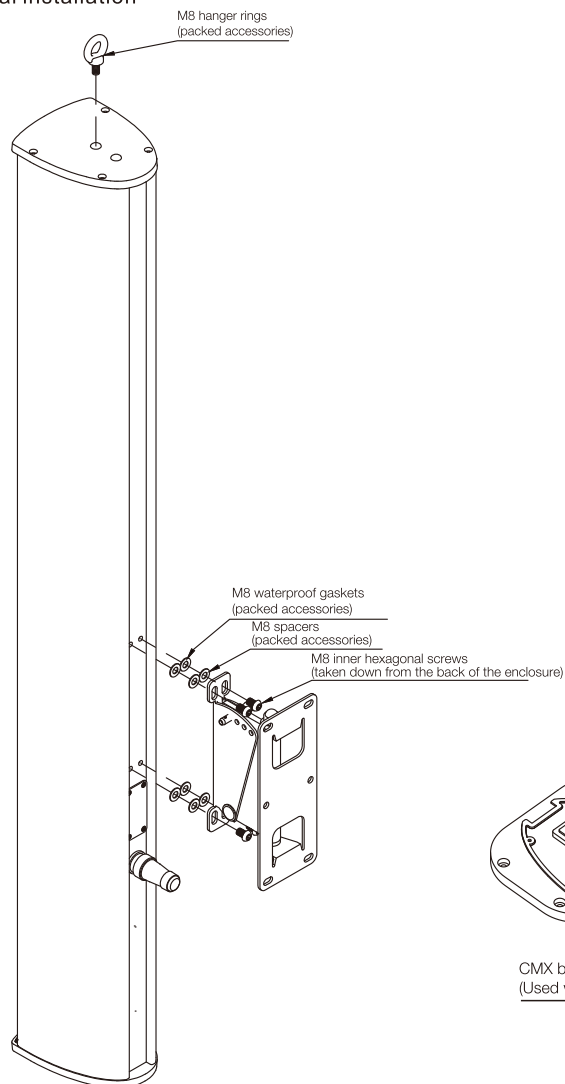

### External Dimensions ■

Unit: mm

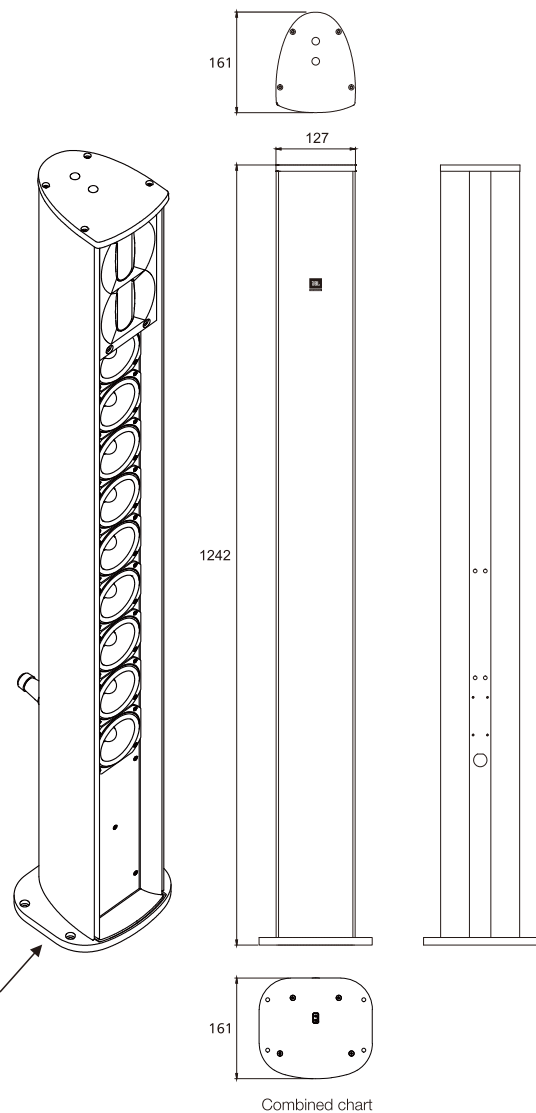

HARMAN Professional 8500 Balboa Blvd. Northridge, CA 91329 USA

© 2021 HARMAN International Industries, Inc. All Rights Reserved.  
Any changes in features, specifications and appearance will be made without prior notice.  
[www.jblpro.com](http://www.jblpro.com)

Issued time: June 2022