

4

3

2

1

THESE DRAWINGS AND SPECIFICATIONS ARE THE PROPERTY OF JBL. INCORPORATED. THEY ARE ISSUED IN STRICT CONFIDENCE AND SHALL NOT BE REPRODUCED OR USED AS THE BASIS FOR MANUFACTURE OR APPARATUS WITHOUT WRITTEN PERMISSION.			
AW266	SALES MODEL, AW266, GRAY		
AW266-BK	SALES MODEL, AW266, BLACK		
AW296	SALES MODEL, AW266, GRAY		
AW296-BK	SALES MODEL, AW296, BLACK		

ALL MATERIAL SPECIFIED ON THIS DRAWING SHALL COMPLY WITH EUROPEAN DIRECTIVE 2002/95/EC. **RoHS**

REVISIONS					
CHG	LTNR	DESCRIPTION	DEPT	D.C	DATE
01592	A	RELEASE TO MARKETING	TH		

D

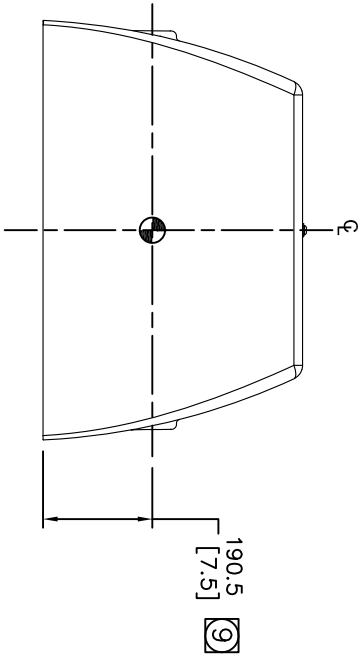

D

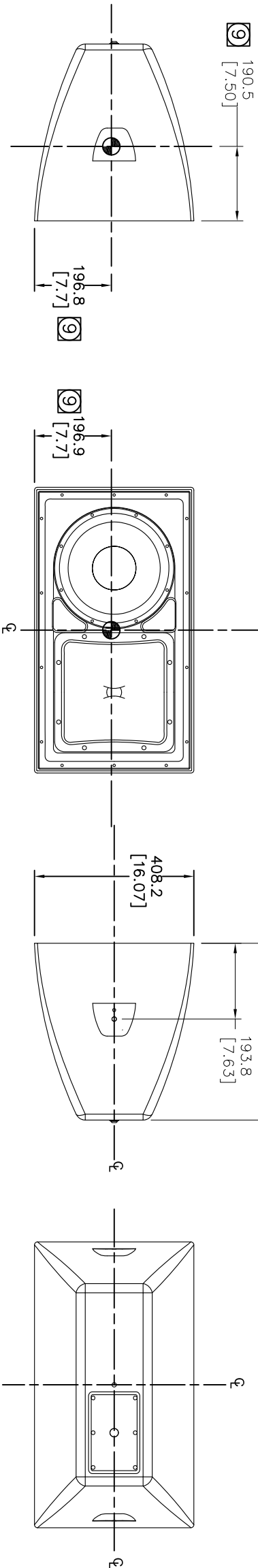

C

C



⑨ INDICATED DIMENSIONS ARE TO CENTER OF GRAVITY (CG) 

7. SUSPENSION ATTACHMENT: 2X M10 ON SIDES FOR INCLUDED U-BRACKET, 2X M6 FOR AIMING STABILIZATION, 1X M10 ON BACK FOR SAFETY.

B

B

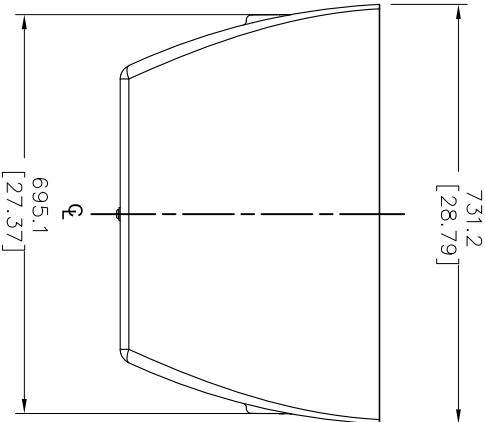

3. GRILLE: 3-LAYER ASSEMBLY OF 16 GA. PERFORATED SS, OPEN CELL FOAM, AND SS MESH. REMOVABLE FOR FIELD SERVICE.

A

A

2. MATERIALS: HAND-LAMINATED FIBER GLASS.
1. FINISH: GRAY GELCOAT, COLOR SIMILAR TO RAL GRAY-WHITE 9002 / PANTONE 420 C.
BLACK ALSO AVAILABLE, COLOR SIMILAR TO RAL JET BLACK 9005 / PANTONE BLACK C.

NOTES: (UNLESS OTHERWISE SPECIFIED)

TOLERANCES
(UNLESS OTHERWISE SPECIFIED)

- X.XX ± .063 INCH
- X.X ± .125 INCH
- ANGULAR TOLERANCE OF 0°±.30°
- FRACTIONAL DIMENSIONS ± 1/32
- * ALL DIMENSIONS ARE FINISHED DIMENSIONS
- * DO NOT SCALE DRAWING



JBL PROFESSIONAL
A Harman International Company
Northridge, California 91329 U.S.A.

CUSTOMER DRAWING: AW2XX

SIZE	DRAWING NO.	REV
A	1000054112	A

SCALE NTS SHEET 1 OF 2

THESE DRAWINGS AND SPECIFICATIONS ARE THE PROPERTY OF JBL INCORPORATED. THEY ARE ISSUED IN STRICT CONFIDENCE AND SHALL NOT BE REPRODUCED OR USED AS THE BASIS FOR MANUFACTURE OR APPARATUS WITHOUT WRITTEN PERMISSION.

ALL MATERIAL SPECIFIED ON THIS DRAWING SHALL COMPLY WITH EUROPEAN DIRECTIVE 2002/95/EC. **RoHS**

BRACKET SCALE 2:1

REVISIONS					
CHG	LTFR	DESCRIPTION	DFT	D/C	DATE

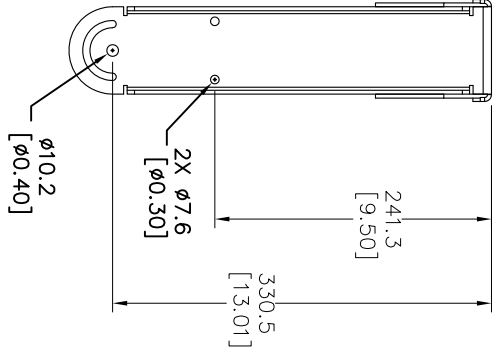
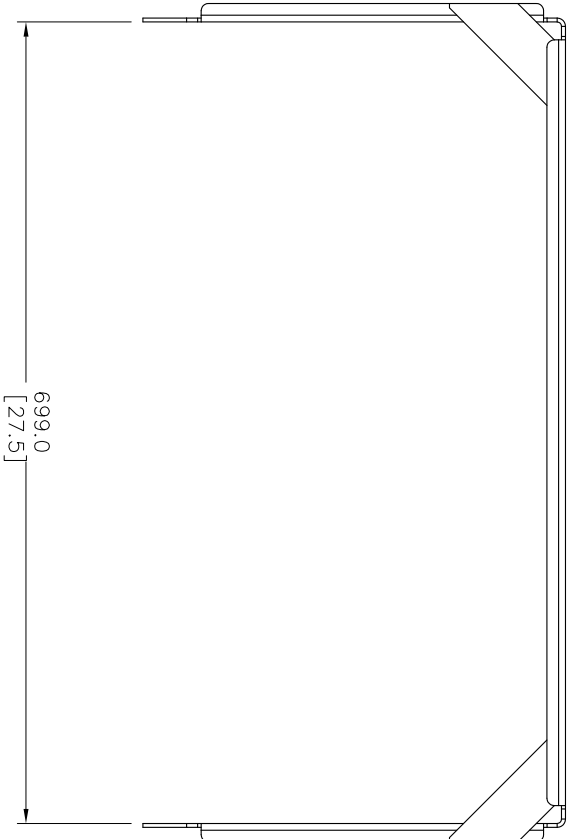
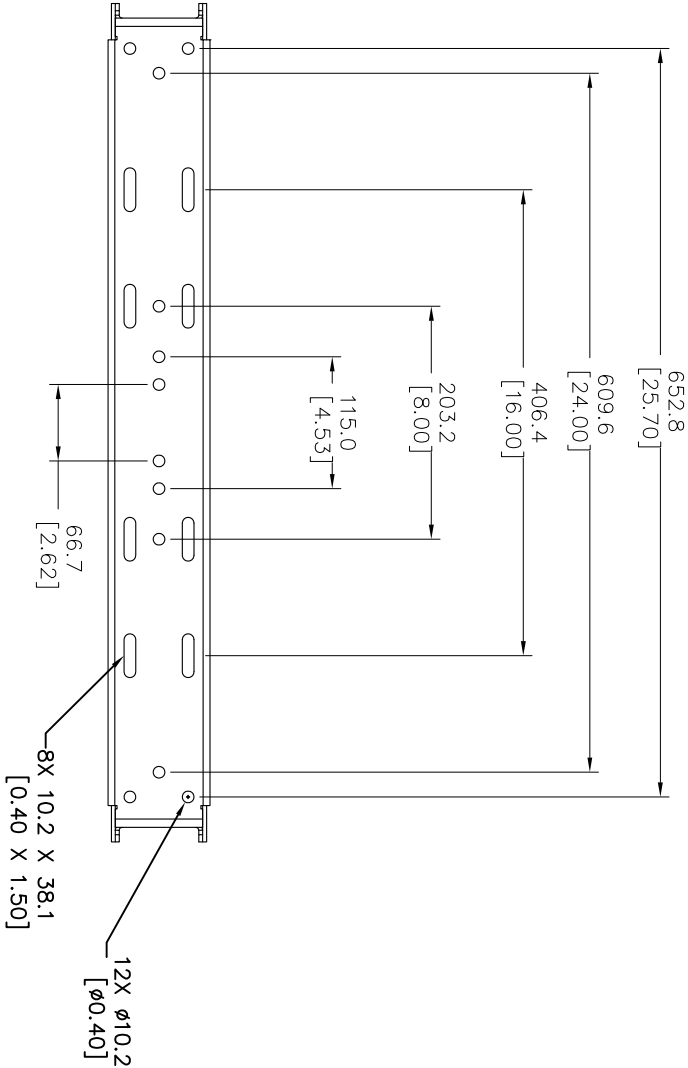

NOTES: (UNLESS OTHERWISE SPECIFIED)

TOLERANCES (UNLESS OTHERWISE SPECIFIED)			JBL PROFESSIONAL A Harman International Company Northridge, California 91329 U.S.A.		
X.XX ± .063 INCH			<div>JBL</div> <div>CUSTOMER DRAWING: AW2XX</div> <div>DRAWING NO. 1000054112</div> <div>REV A</div>		
X.X ± .125 INCH					
ANGULAR TOLERANCE OF 0°±30°					
FRACTIONAL DIMENSIONS ± 1/32					
* DIMENSIONS ARE INCHES			SCALE NTS SHEET 2 OF 1		
* ALL DIMENSIONS ARE FINISHED DIMENSIONS					
* DO NOT SCALE DRAWING					